

# ER KALIP





**ENCLOSED AREA : 5400m<sup>2</sup>**



# CAE / CAD / CAM / PLANNING SOFTWARES

## **SIMULATION (CAE)**

**Auto Form R8 : 1 station**  
**FTI Forming Suite : 1 station**  
**ANSYS R.17 : 1 station**  
**Ls-Dyna/Dynaform : 1 station**

## **DESIGN (CAD)**

**Catia V5 : 17 stations**  
**Siemens NX 12.0 : 2 station**

## **MILLING (CAM)**

**Catia RM2 : 1 stations**  
**Tebis V4,0 R6 (3D) : 2 stations**  
**Tebis V4,0 R6 (2D) : 1 station**

## **PRODUCTION**

**Tebis Viewer : 16 stations**

## **PLANNING (Intelligent Scheduling)**

**IPS : All dept.'s**



	<b>NICOLAS CORREA FP50-50</b>	<b>X 5000</b>	<b>Y 3100</b>	<b>Z 1300</b>	<b>25 t</b>
	<b>SNK RB 4VS (M)</b>	<b>X 4000</b>	<b>Y 2400</b>	<b>Z 1800</b>	<b>20 t</b>
	<b>KAOMING KMC</b>	<b>X 4000</b>	<b>Y 2100</b>	<b>Z 1500</b>	<b>8 t</b>
	<b>OKUMA MVC-AII</b>	<b>X 3000</b>	<b>Y 2000</b>	<b>Z 1550</b>	<b>10 t</b>
	<b>SNK RB 2NS (M)</b>	<b>X 2500</b>	<b>Y 1700</b>	<b>Z 1350</b>	<b>5 t</b>
	<b>SNK RB 2NS (M)</b>	<b>X 2500</b>	<b>Y 1700</b>	<b>Z 1350</b>	<b>5 t</b>
	<b>VTEC VB 25-20</b>	<b>X 2500</b>	<b>Y 2000</b>	<b>Z 800</b>	<b>10 t</b>
	<b>AWEA BM1600</b>	<b>X 1600</b>	<b>Y 800</b>	<b>Z 800</b>	<b>2 t</b>
	<b>MAHO 80 5-AXIS</b>	<b>X 800</b>	<b>Y 700</b>	<b>Z 600</b>	<b>0,6 t</b>

# LASER CUTTING ( 5 Axis )



**MAZAK SPACE GEAR 510 MKII 5 AXIS 1800 W**  
**3050 x 1525 x 420 mm**

# 3D MEASUREMENT SYSTEMS



**DEA MEASURING MACHINE  
(PC-DMIS SOFTWARE)  
2500 x 3300 x 1500mm**



**ATOS II  
REVERSE ENGINEERING + RAPID  
MILLING**

**175 x 140 – 2000 x 1600 mm<sup>2</sup>**

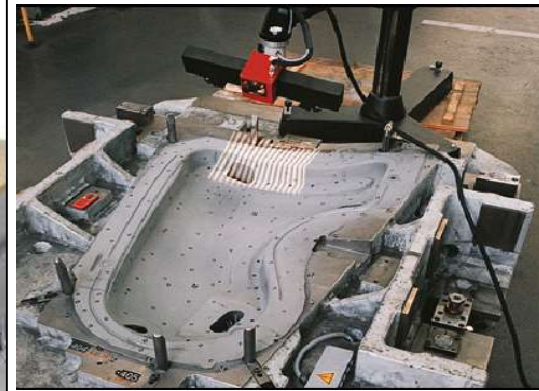

# TRY-OUT PRESSES



**1500 T MÜLLER  
HYDRAULIC  
5000 x 2700 mm**

**G1**

**1200 T HIDROMODE  
HYDRAULIC  
4000 x 2000 mm**

**G2**

**100 T MÜLLER  
HYDRAULIC  
3900 x 2300 mm**

**G2**

**400 T WEINGARTEN  
ECCENTRIC  
1800 x 1400 mm**

**G3**

## ERMETAL SERIAL PRESS LINES

Line 1: DA 1500 t + SA 4x800 t

Line 2: DA 1600 t + SA 4x800 t

Line 3: DA 1630 t + SA 4x800 t

Line 4: DA 1400 + SA 4x500 t

Line 5: SA 4x800 t



# OUR CUSTOMERS



PSA PEUGEOT CITROËN



TOYOTA



FORD OTOSAN



TOYOTA BOSHOKU





# ROOF PROJECTS IN ERKALIP



**FIAT DOBLO  
2010**



**FORD B299  
2013**



**PSA K0  
2014**



**FIAT356 SEDAN  
2014**



**FIAT 356 SW  
2015**

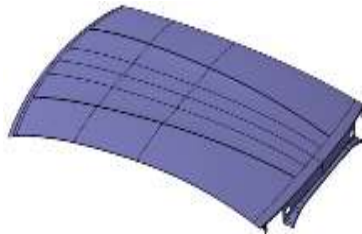

**PSA R83 TN  
2016**



**PSA R83 TO  
2016**

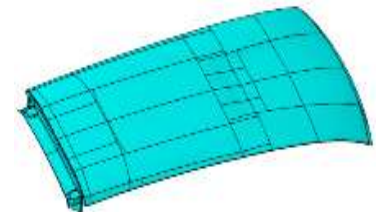

**PSA R82 TN  
2016**



**PSA R82 TO  
2016**



**PSA P21 TN  
2017**



**PSA P21 TO  
2017**



**PSA M44  
2017**

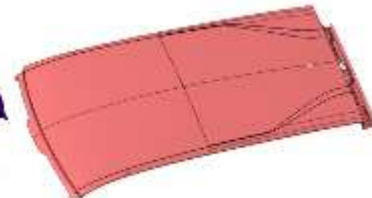

**PSA P24  
2017**

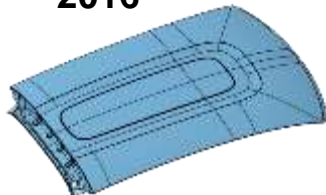

**PSA B618  
2018**



**PSA D41 TN  
2018**



**PSA D41 AR  
2018**



**PSA C41 TN  
2018**



**PSA C41 AR  
2018**

# QUALITY CERTIFICATE

## TS EN ISO 9001:2015 Quality Management System



**CERTIFICATE**

Management system as per  
**ISO 9001 : 2015**

In accordance with TUV NORD CERT procedures, it is hereby certified that



**Erkalip Kalıp Makina Metal Eşya San. ve Tic. A.Ş.**  
Demirtaş Organize Sanayi Bölgesi, 1. Nilüfer Sok., No 11, Osmangazi,  
TR-16369 Bursa,  
Turkey

issues a management system in line with the above standard for the following scope

**Design, production and sales of sheet metal trimming dies, forming dies,  
checking fixtures and welding apparatus**

Certificate Registration No. 44 100 333046-002  
Azul Reg. No. TR 090

Valid from 2018-04-27  
Valid until 2021-04-26  
Initial certification 2000



Certification Body  
at TUV NORD CERT GmbH

Istanbul, 2018-04-27

This certification was conducted in accordance with the TUV NORD CERT auditing and certification procedures and is subject to regular surveillance audits. This certificate is valid in conjunction with the main certificate.

TUV NORD CERT GmbH      Langenstraße 20      40141 Essen      www.tuv-nord-cert.com

# QUALITY CERTIFICATE

## TS EN ISO 14001:2015 Environmental Management System



**CERTIFICATE**

Management system as per  
**ISO 14001 : 2015**

In accordance with TUV NORD CERT procedures, it is hereby certified that:



**Erkalip Kalıp Makina Metal Eşya San. ve Tic. A.Ş.**  
Demirtaş Organize Sanayi Bölgesi, 1. Nilüfer Sok., No 11, Osmangazi,  
TR-16369 Bursa,  
Turkey

applies a management system in line with the above standard for the following scope:

**Design, production and sales of sheet metal trimming dies, forming dies,  
checking fixtures and welding apparatus**

Certificate Registration No.: 04 104 000891-001  
Audit Report No.: TR-063

Valid from 2015-04-27  
Valid until 2021-04-28  
(Initial certification 2000)



Certification Body  
at TUV NORD CERT GmbH

Istanbul, 2015-04-27

This certification was conducted in accordance with the TUV NORD CERT auditing and certification procedures and is subject to regular surveillance audits. This certificate is valid in conjunction with the main certificate.

TUV NORD CERT GmbH    Lasgerhardsstraße 20    42541 Essen    www.tuv-nord-cert.com



# PSA BENCHMARK

## 2006 - 2016



% die rework in PSA (mh)

Relationship / Organisation

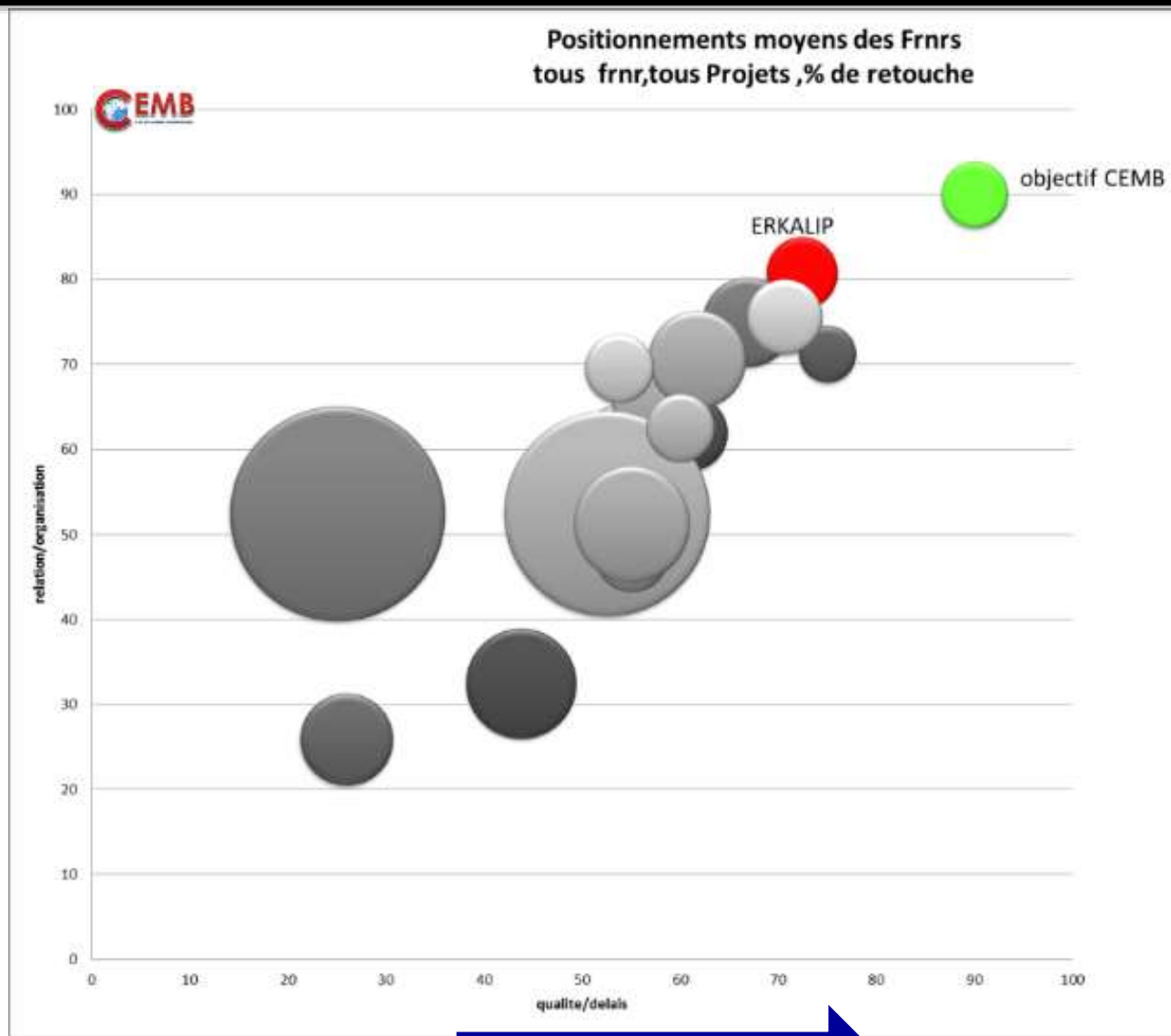

Quality / Leadtime (delays)

46 Parts in Serial Production

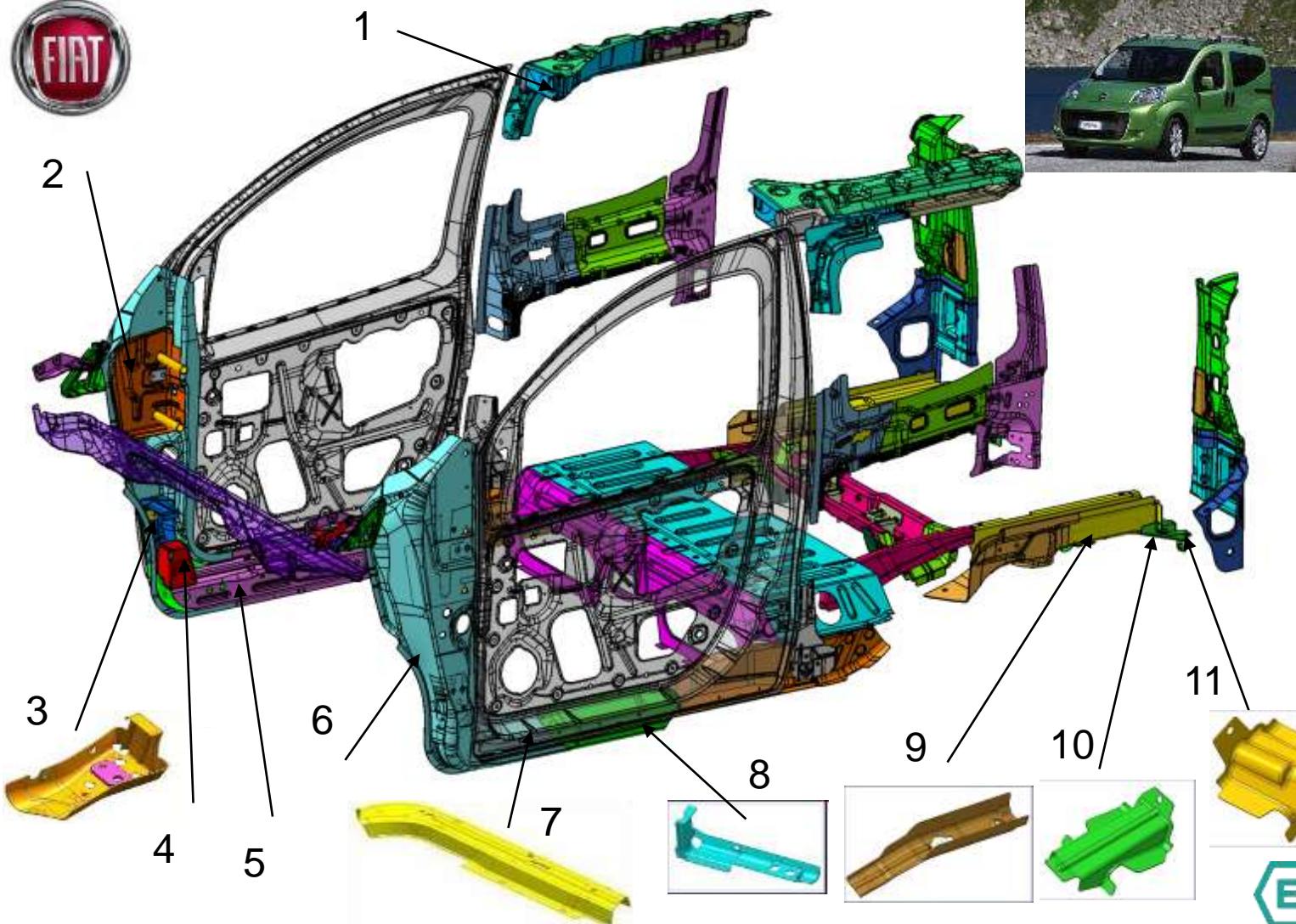

- 1- FE600 DP
- 2- FE600 DP
- 3- FE600 DP
- 4- FE600 DP
- 5- FE800 DP
- 6- FE600 DP
- 7- FE600 DP
- 8- FE600 DP
- 9- FE600 DP
- 10- FE600 DP
- 11- FE600 DP



# FIAT-TOFAS

## DOBLO - HSS PARTS

56 Parts in Serial Production

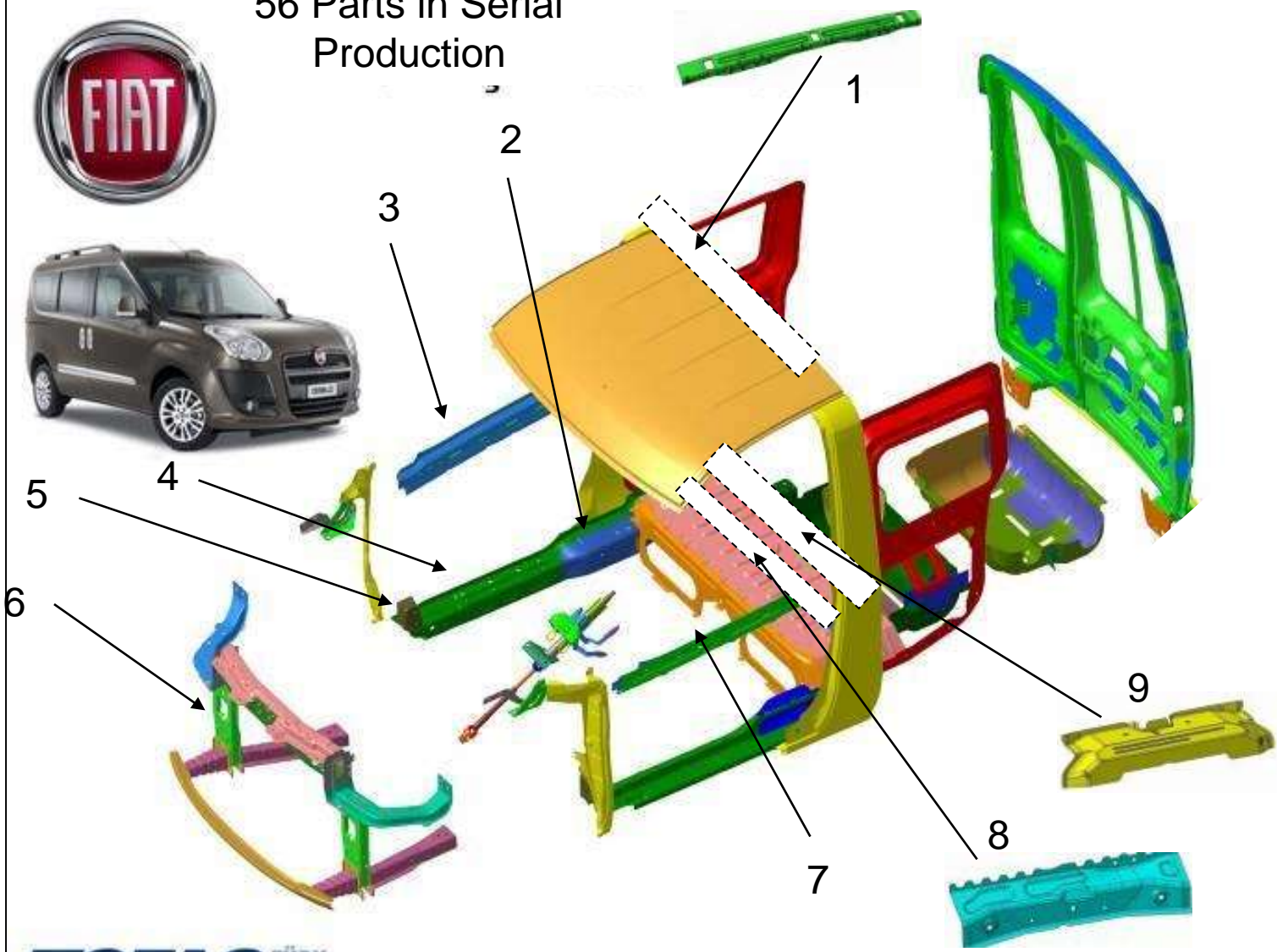

- 1- FE600 DP
- 2- FE800 DP
- 3- FE800 DP
- 4- FE800 DP
- 5- FE600 DP
- 6- FE600 DP
- 7- FE800 DP
- 8- FE600 DP
- 9- FE600 DP



# RENAULT FLUENCE

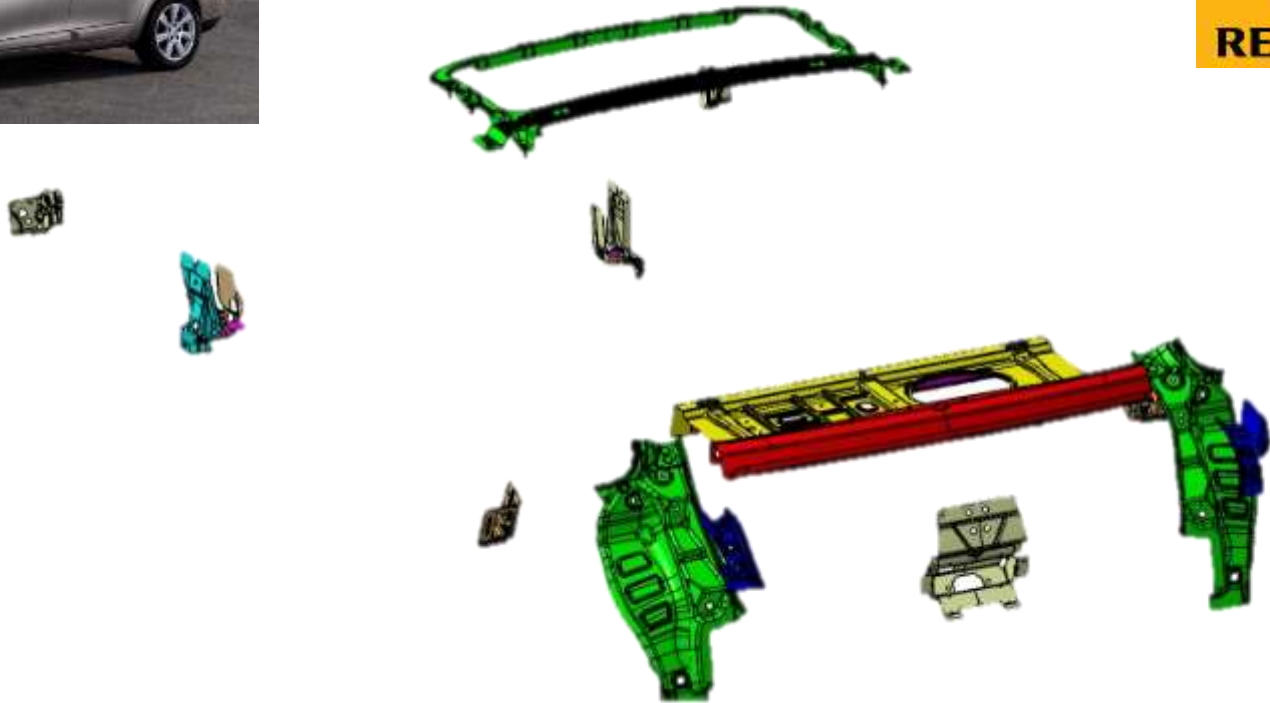

18 Parts in Serial Production

# RENAULT CLIO IV

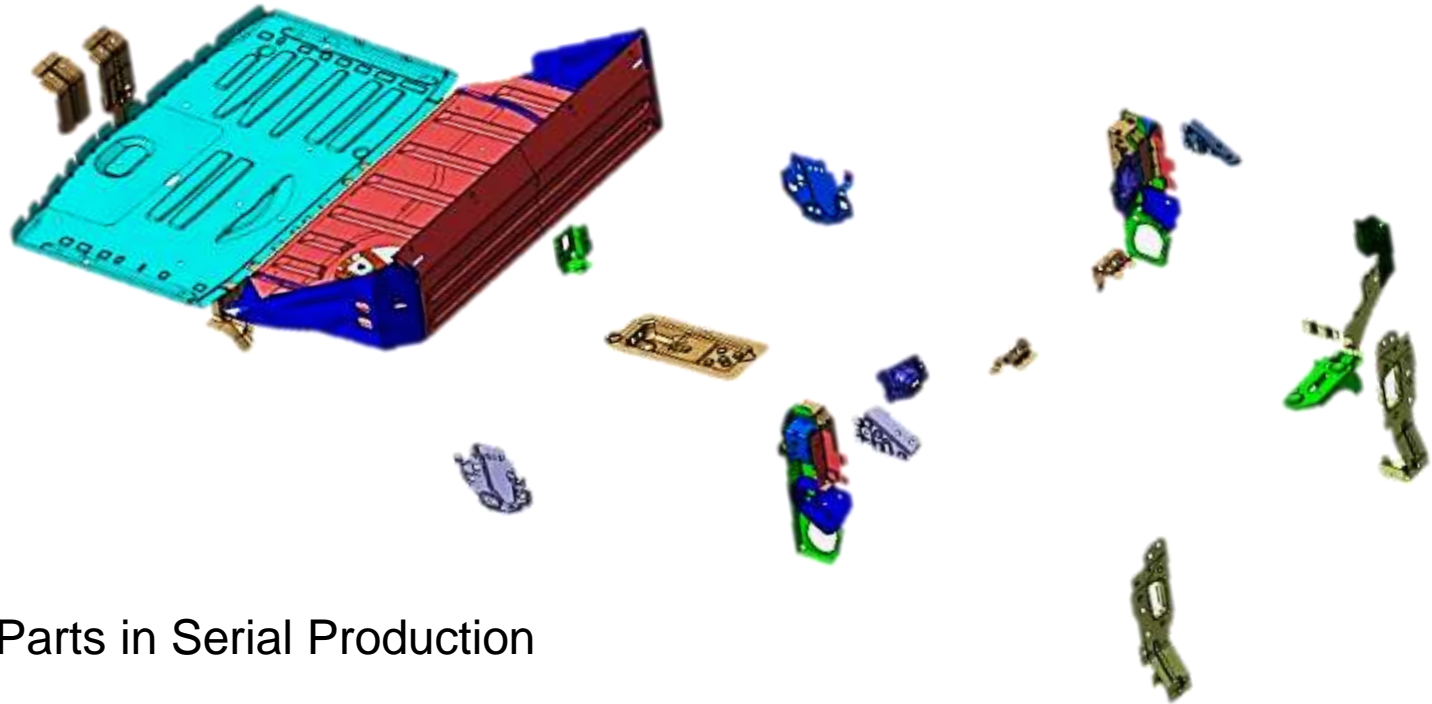

49 Parts in Serial Production

# FORD TOURNEO CUSTOM CONCEPT



67 Parts in Serial Production



# FORD TRANSIT

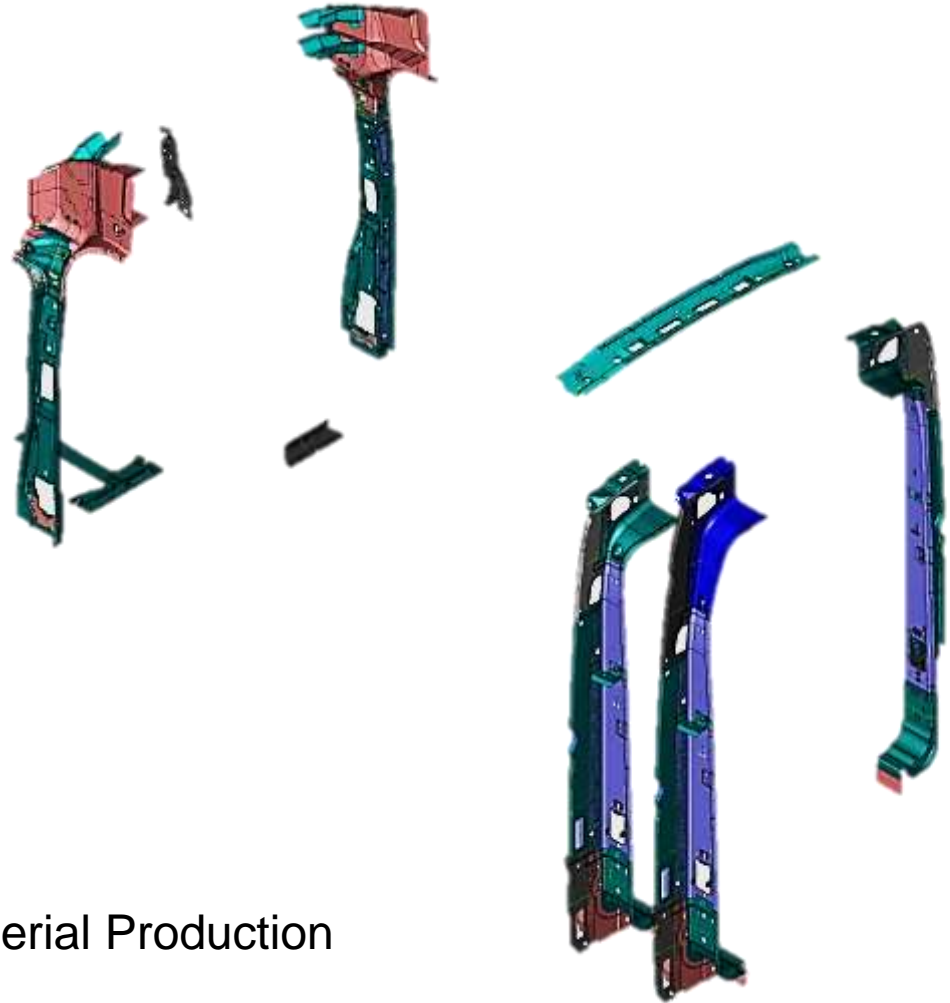

60 Parts in Serial Production

# PSA C84E

## Panneau Porte Avant D&G



\* We have completed front / rear door outer projects .

# SCHULER - VW CRAFTER

## Schiebetür Innen Links H3

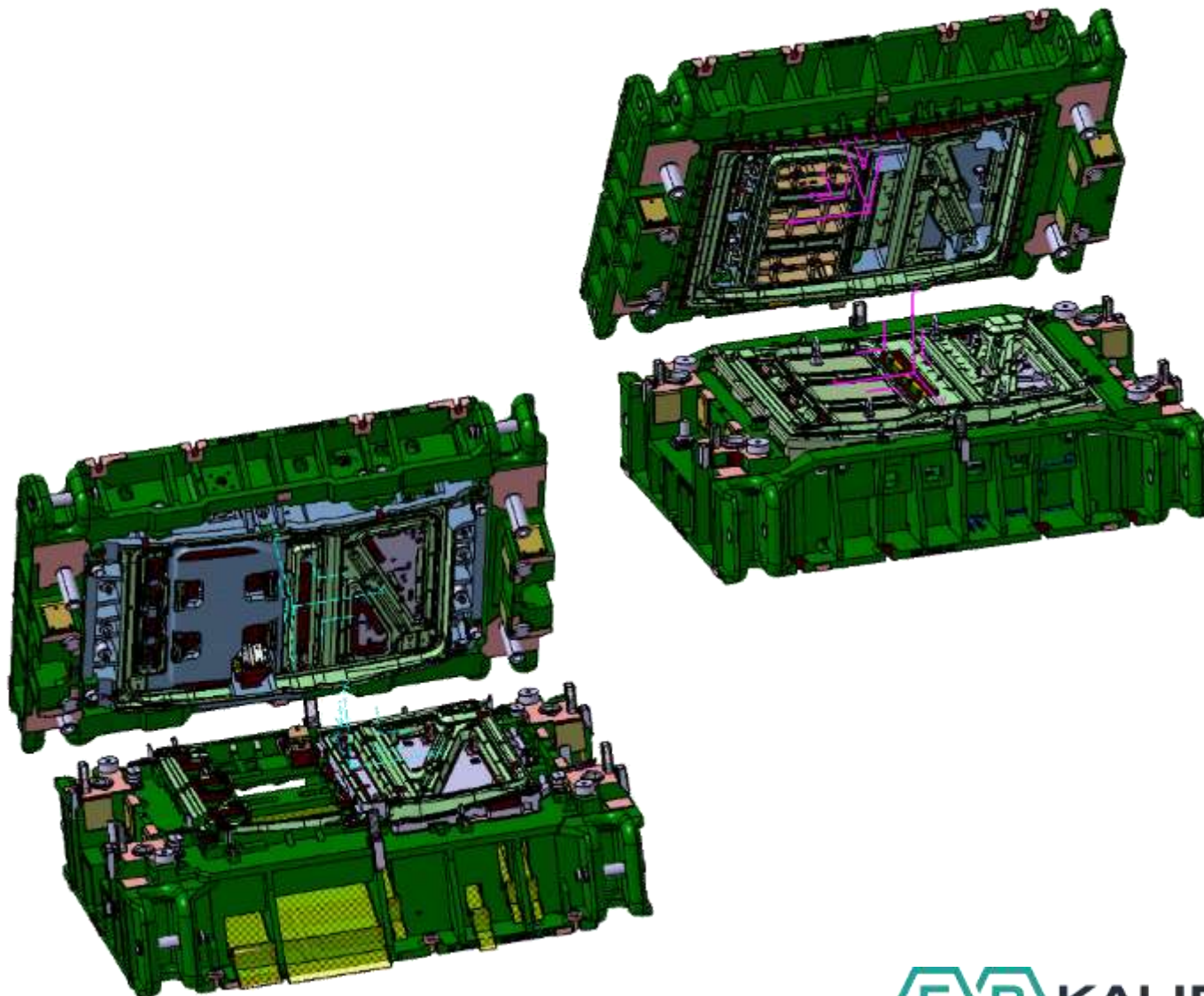
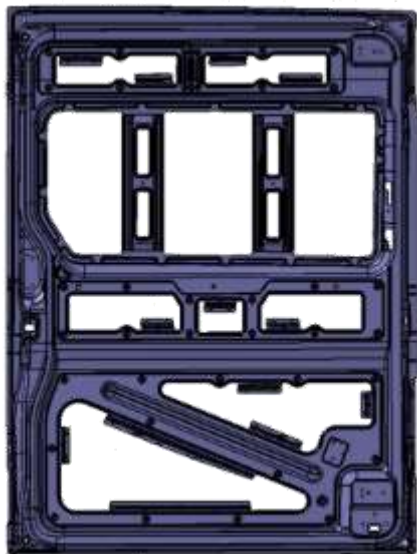



# PSA B785 PROJECT

## Rear Door Inner

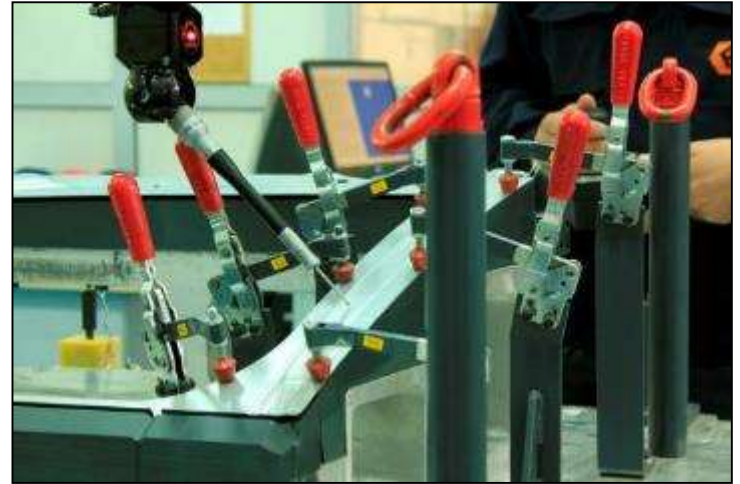

# TOYOTA BOSHOKU 466A Seat Cushion Fr

12 Step Progressive Die

SPM : 57 shot/min

Coil Width : 496 mm

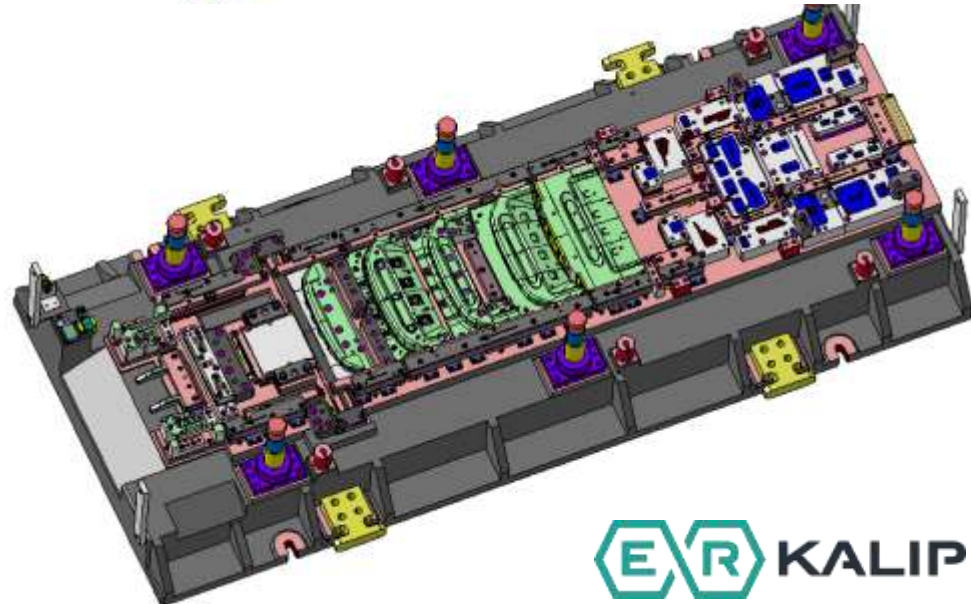
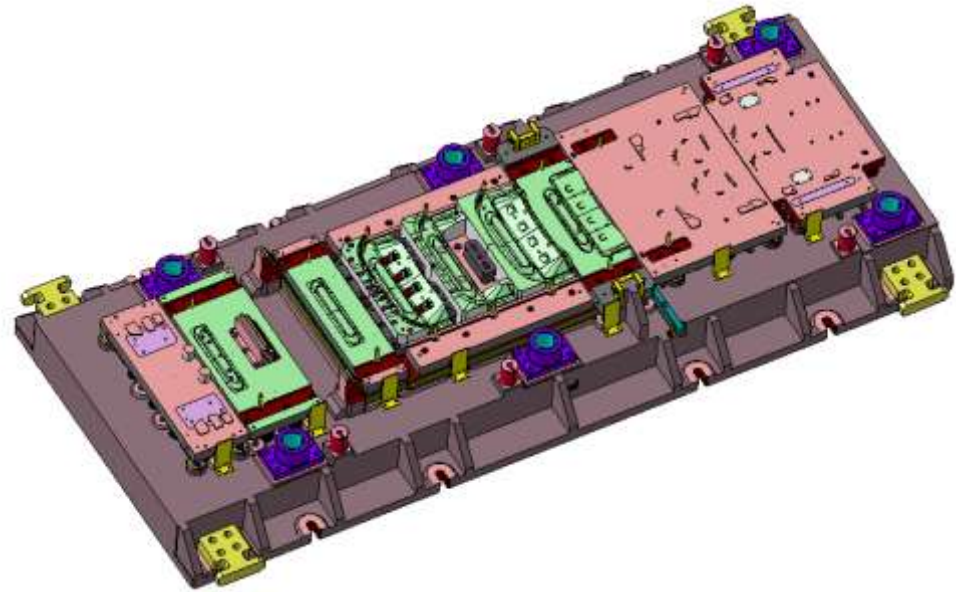
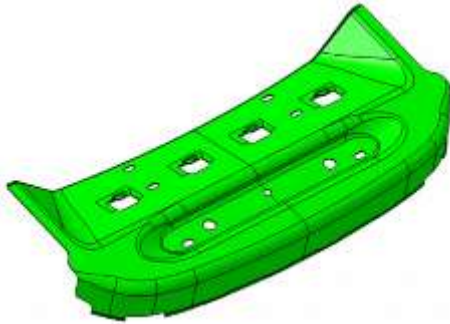



# PSA – D34 PROJECT

## Bodyside Outer Panel (OP40)

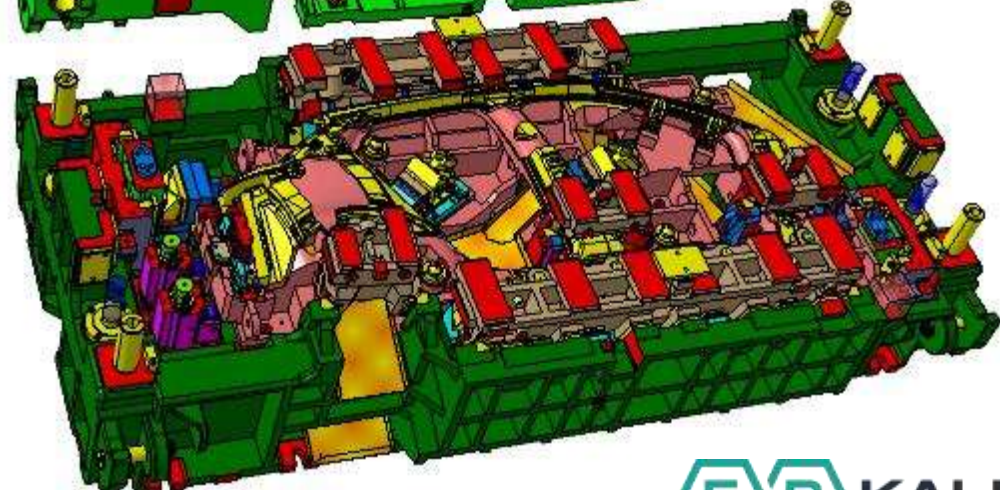
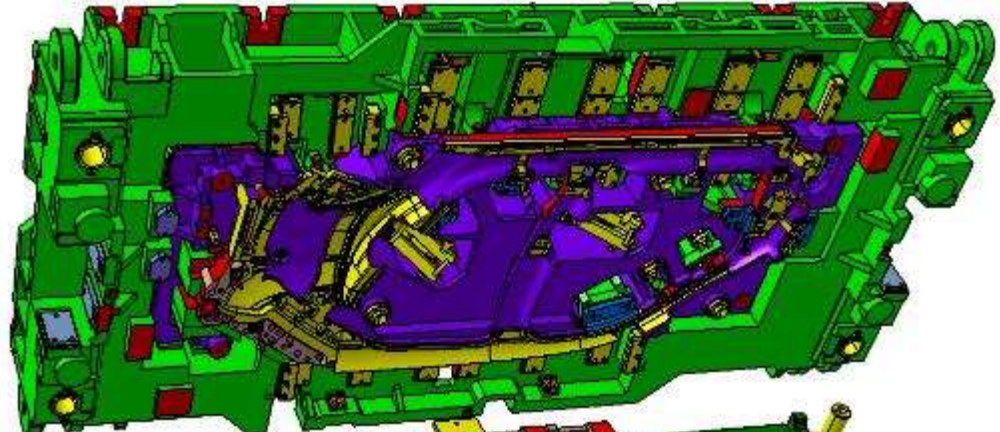



# PSA – D41 PROJECT PAVILLON TN & AR

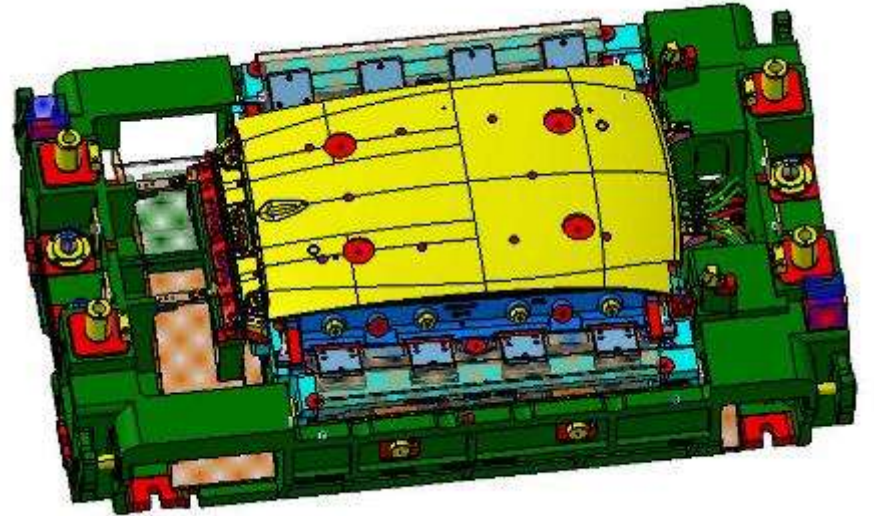
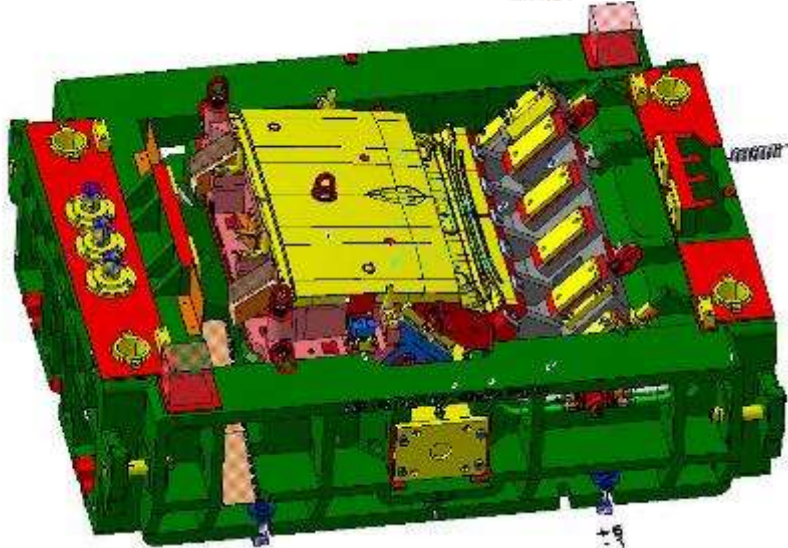
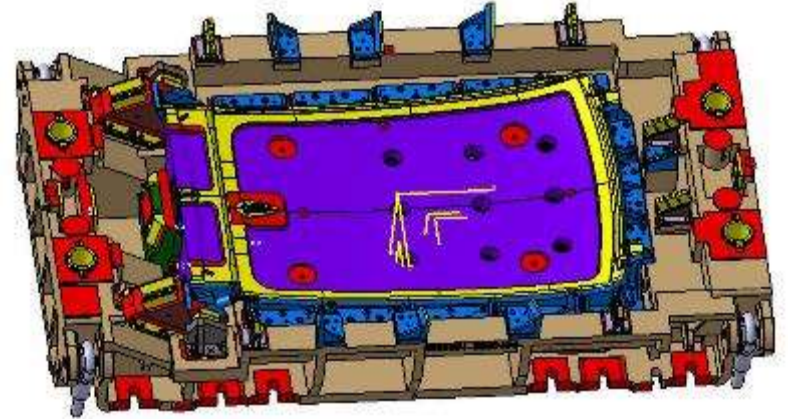
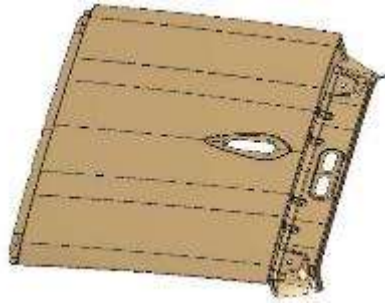
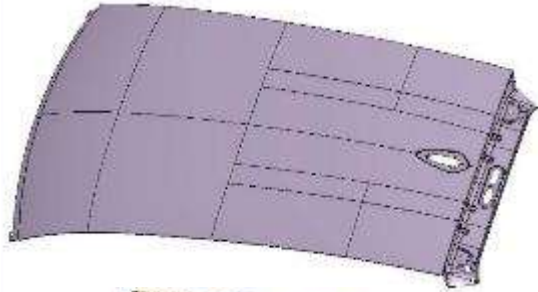



# PSA – C41 PROJECT

## VOLET & DOUBLURE VOLET & Traverse Cent. Volet

