A background image of a multi-lane highway stretching into the distance, shrouded in a thick, white fog. A single truck is visible in the distance on the right side of the road. The overall tone is light and atmospheric.

**Leaders in the design and production of security elements
for heavy duty truck suspension**

Since 1963

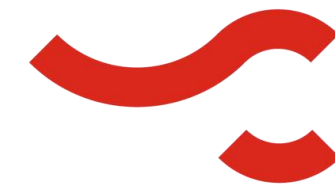

55

Years experience in leaf springs



300

Employees

50 M€

R&D investment since 2000



85%

Annual exports

HIGHLIGHTS



Full service
supplier

Product Design
R&D
Manufacturing
Suppliers engineering
Testing & Homologation

Production
plants

MBHA
Spain

BALDUR
Turkey

FLEXIMOL
Portugal

ZIUR
Spain

Engineering

MBHA
PROJECTS
Spain

THE GROUP



FLEXIMOL

BALDUR

MBHA PROJECTS

MBHA

ZIUR

GLOBAL FOOTPRINT

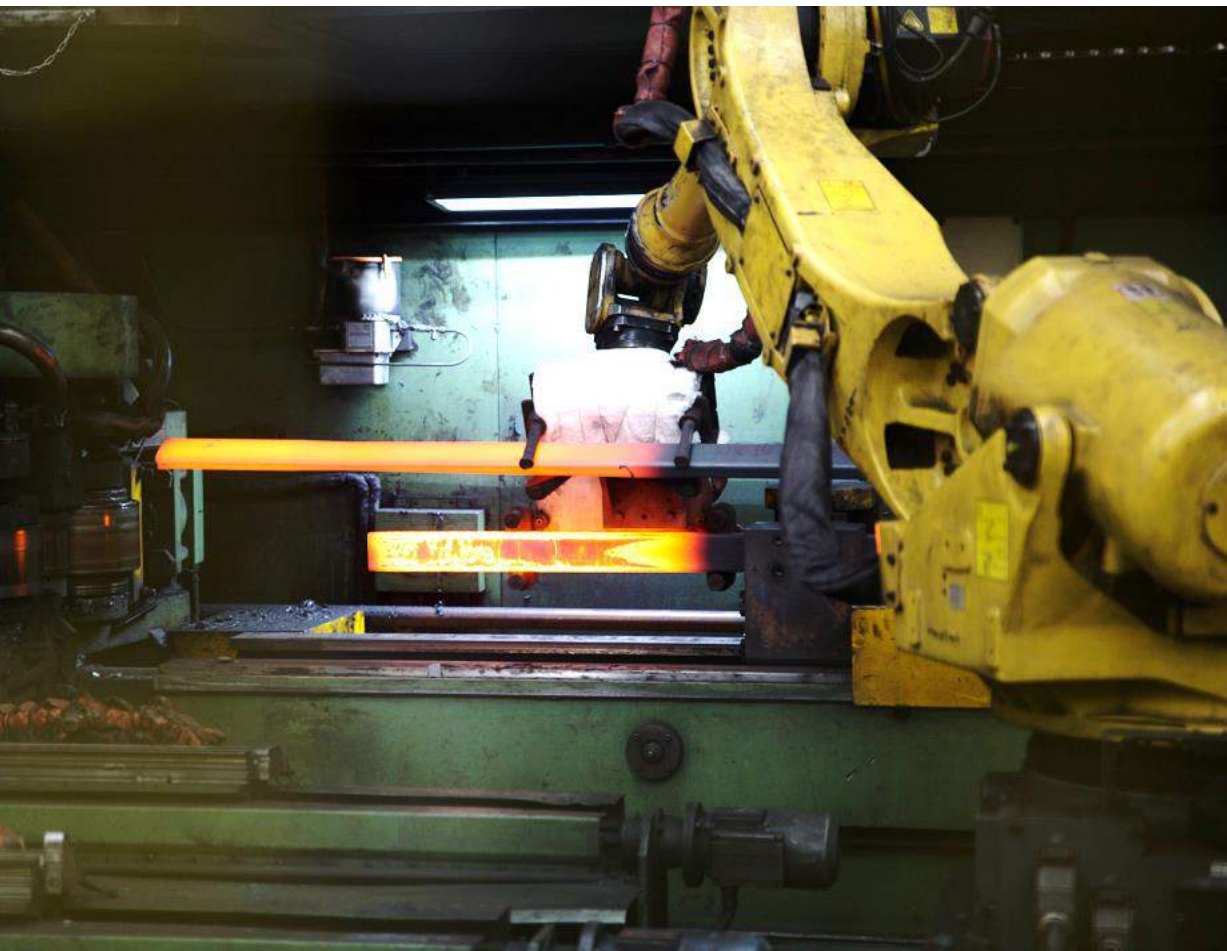
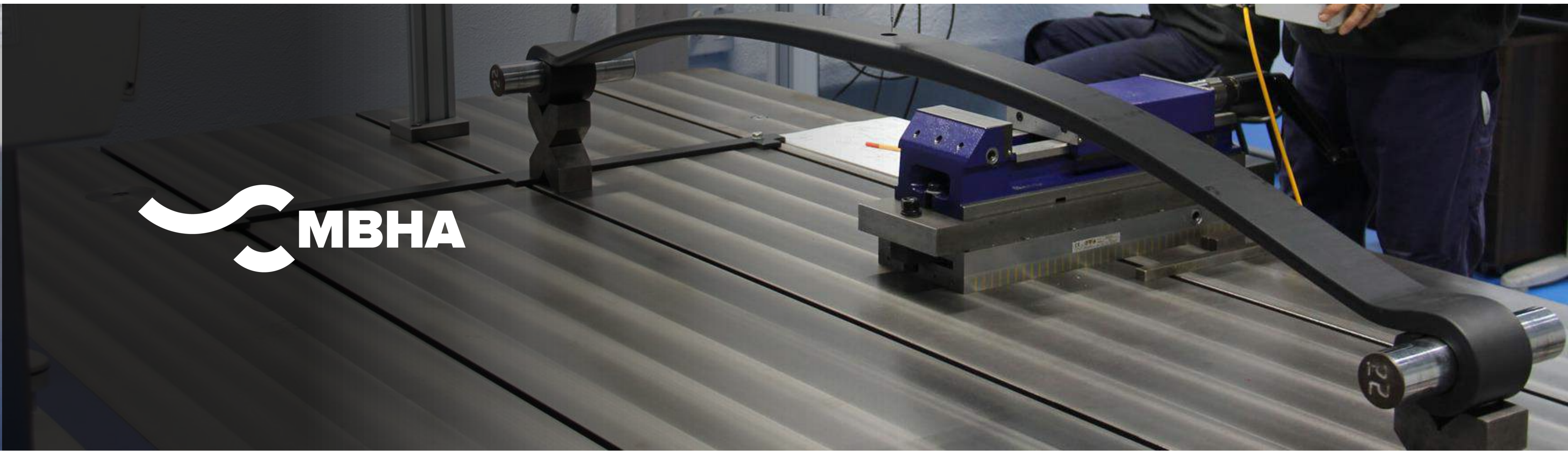



ISUZU



IVECO



SCANIA





Monoleaf



Parabolic



Conventional



multileaf



Trailer ARM



PRODUCT PORTFOLIO

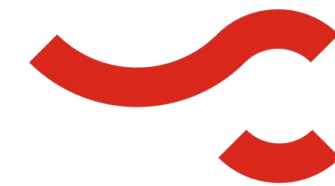

750

References developed



200

In current production

>700k

leaf springs produced/year



55%

market share

MAIN FACTS



▼ Weight



▼ Prices



▲ Performance



▲ Quality

CHALLENGES



Customer
Design Inputs or
Own Proposals



Design
Process
|
Detailed
Engineering



Prototype
Manufacturing
|
Prototype
rig test
|
Prototype
Vehicle Test



Validation
& SOP

PRODUCT LAUNCH CYCLE

44.8%

Weight Reduction

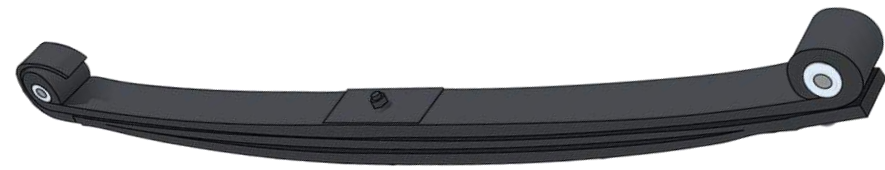

4-leaf parabolic spring

Axle load 7.5 To

Stress level:

Static load: 726 MPa

Maximum load: 1050 Mpa

Weight: 78.8 Kg



**1-leaf parabolic sprin
(3 leaves reduction)**

Axle load 7.5 To

Stress level:

Static load: 884 MPa

Maximum load: 1357 Mpa

Weight: 43.48 Kg



MBHA
developed
the following new
suspensions for the
Euro 6 with their
customers

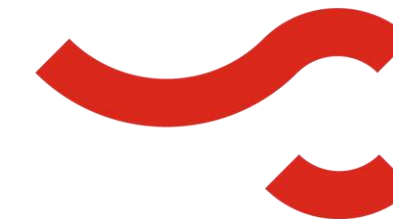

Daimler

14 new front springs and 5 new rear springs for the New Actros, Arocs, Antos; and 11 new rear springs and 2 new front springs for the New Atego

Volvo/Renault

18 new front springs for the new models

Nissan

11 new front and rear springs for the NT500

Isuzu

4 new front and rear leaf spring

ZIUR COMPOSITES

WE MAKE A LIGHTER WORLD

ZIUR COMPOSITES



Plug and play solutions

New designs

Quality assurance

ZIUR



Monoleaf



Parabolic



Conventional



Anti-roll
Bar



Stabilenke

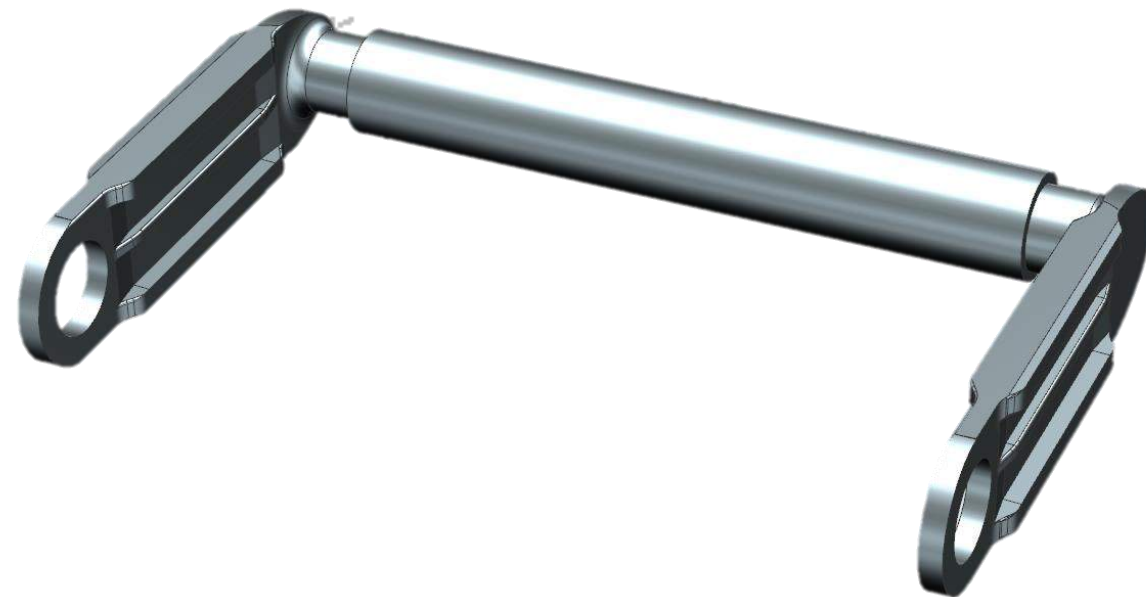

Stabilizer Shackle



THE NEXT GENERATION

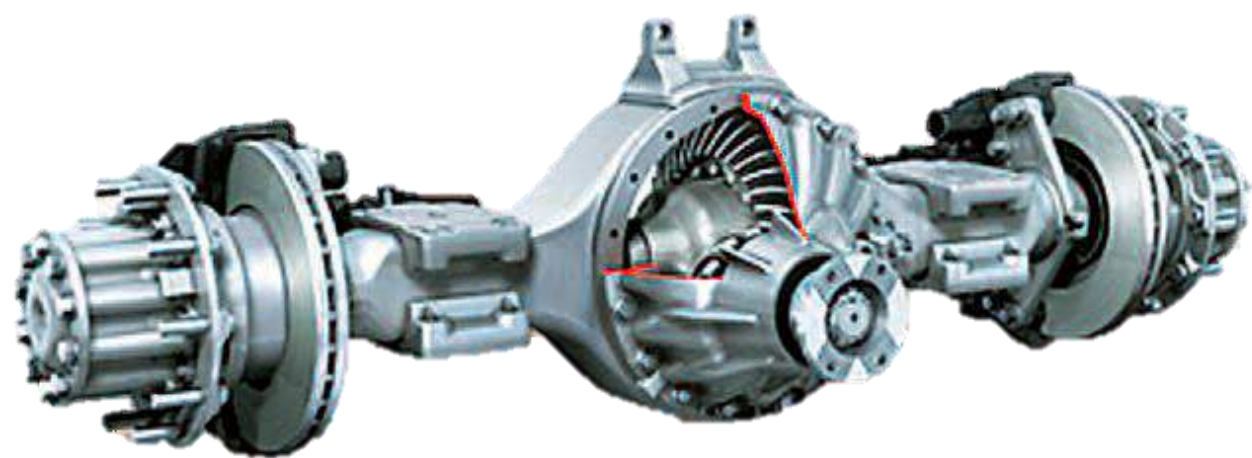

THE FUTURE



TESTING

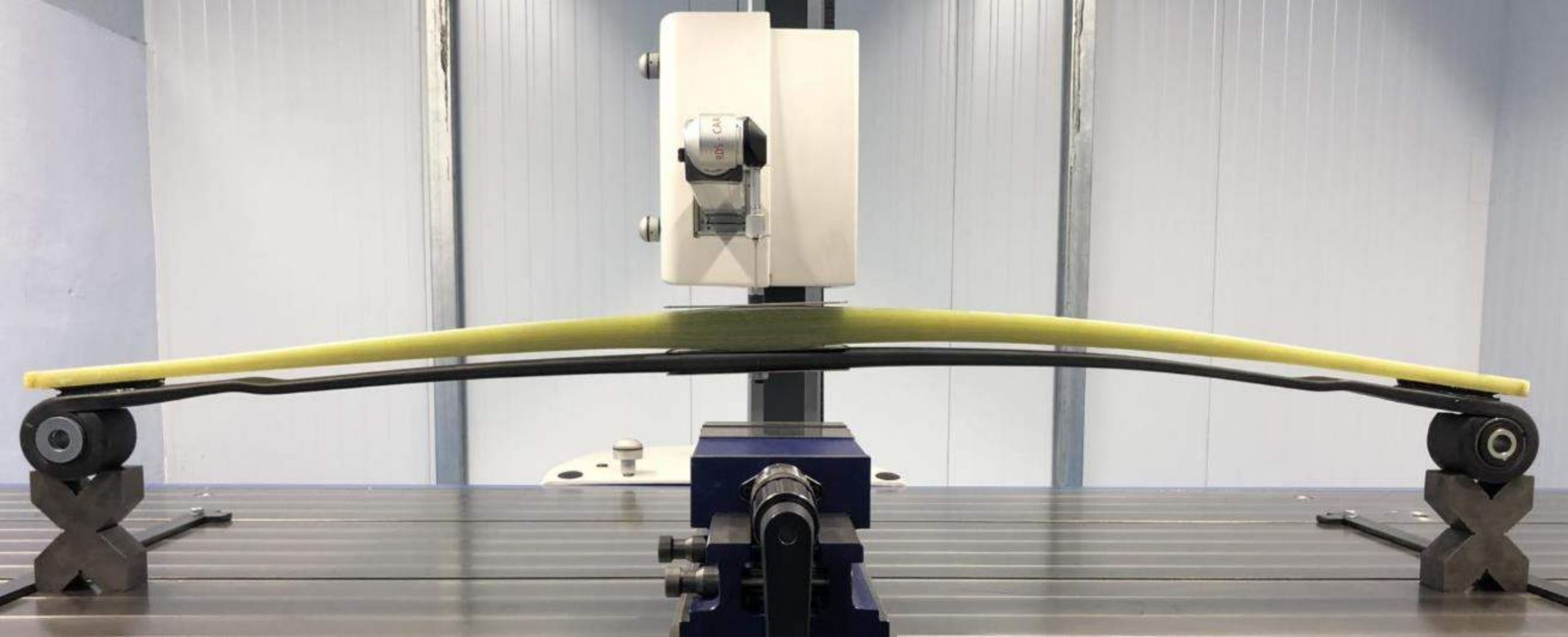

CERTIFICATIONS

A wide-angle, high-angle shot of a multi-lane highway shrouded in thick fog. The road stretches into the distance, with white lane markings and a central divider. On the right side, a blue overhead sign with white text reads "Ausfahrt" (Exit). A few vehicles, including a car and a truck, are visible in the distance, their forms softened by the mist. The overall atmosphere is hazy and atmospheric.

Why be a MBHA partner?



**Ethical conduct and
Cultural diversity**

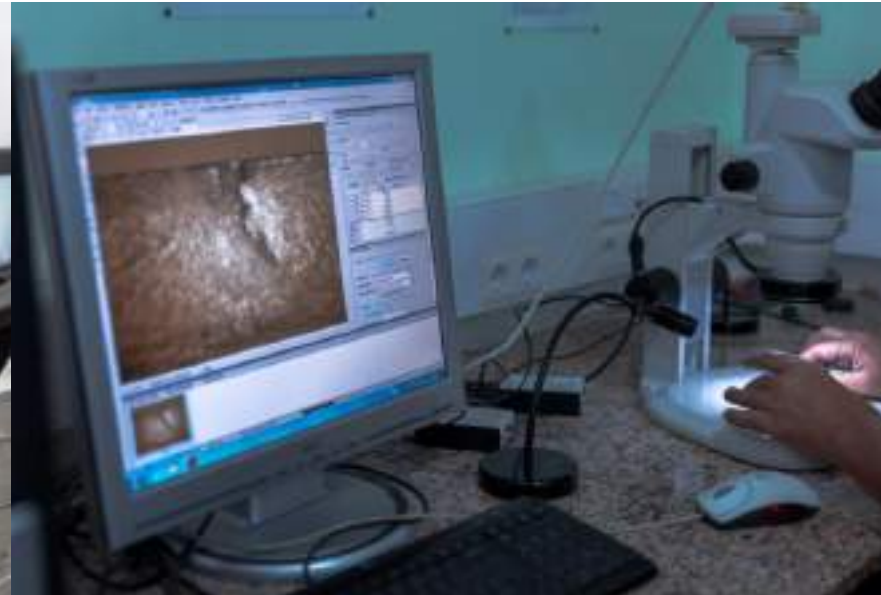

**Efficiency, Sacrifice,
Quality**



**Experience and continuous
improvement**



**Customer focus
and innovation**



**Corporate social
responsibility**



**Health and
Safety**

OUR VALUES



We foster participation throughout the company, sharing efforts and know-how to achieve one common goal.

Without teamwork, there is no success.

OUR TEAMWORK



Thanks for your attention