



Nuova Simach

Design, dies construction and stamping.

www.nuovasimach.it

NUOVA SIMACH S.r.l. is located in Lusigliè, in province of Turin. It was founded in 1977 as factory of die and tooling construction, as well as the cold stamping of metal sheet and other metals.

Company details:

Our plant currently occupies 8000 Sqm

Tooling construction per year: about 100 tools

Metallic stamped parts per month: about 40.000.000 Pcs

Employees : 60



TURNOVER AND FORECAST

Our business is **constantly expanding**,
in Italy and in foreign markets,
with steady growth every year

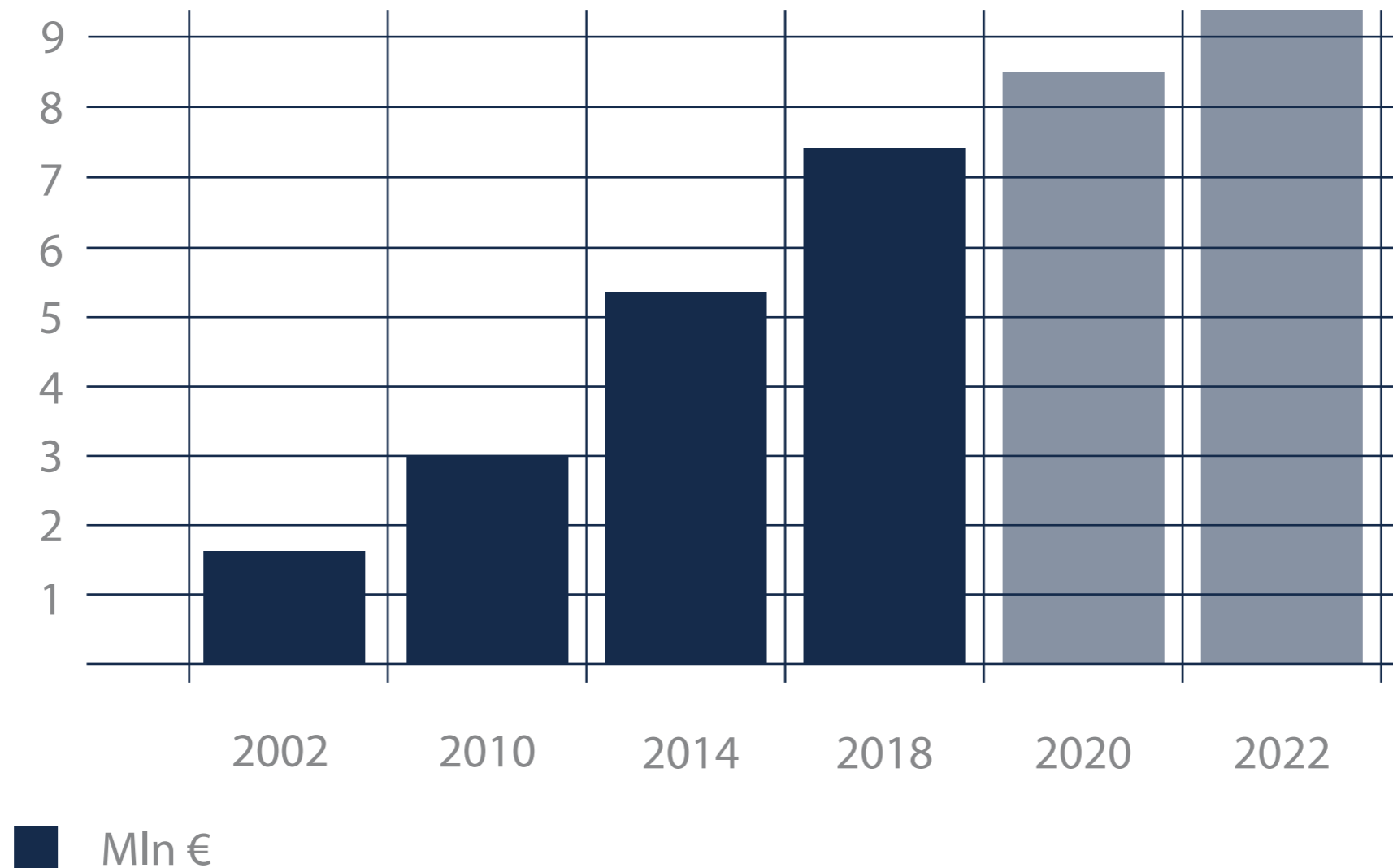

ORGANIZATION CHART

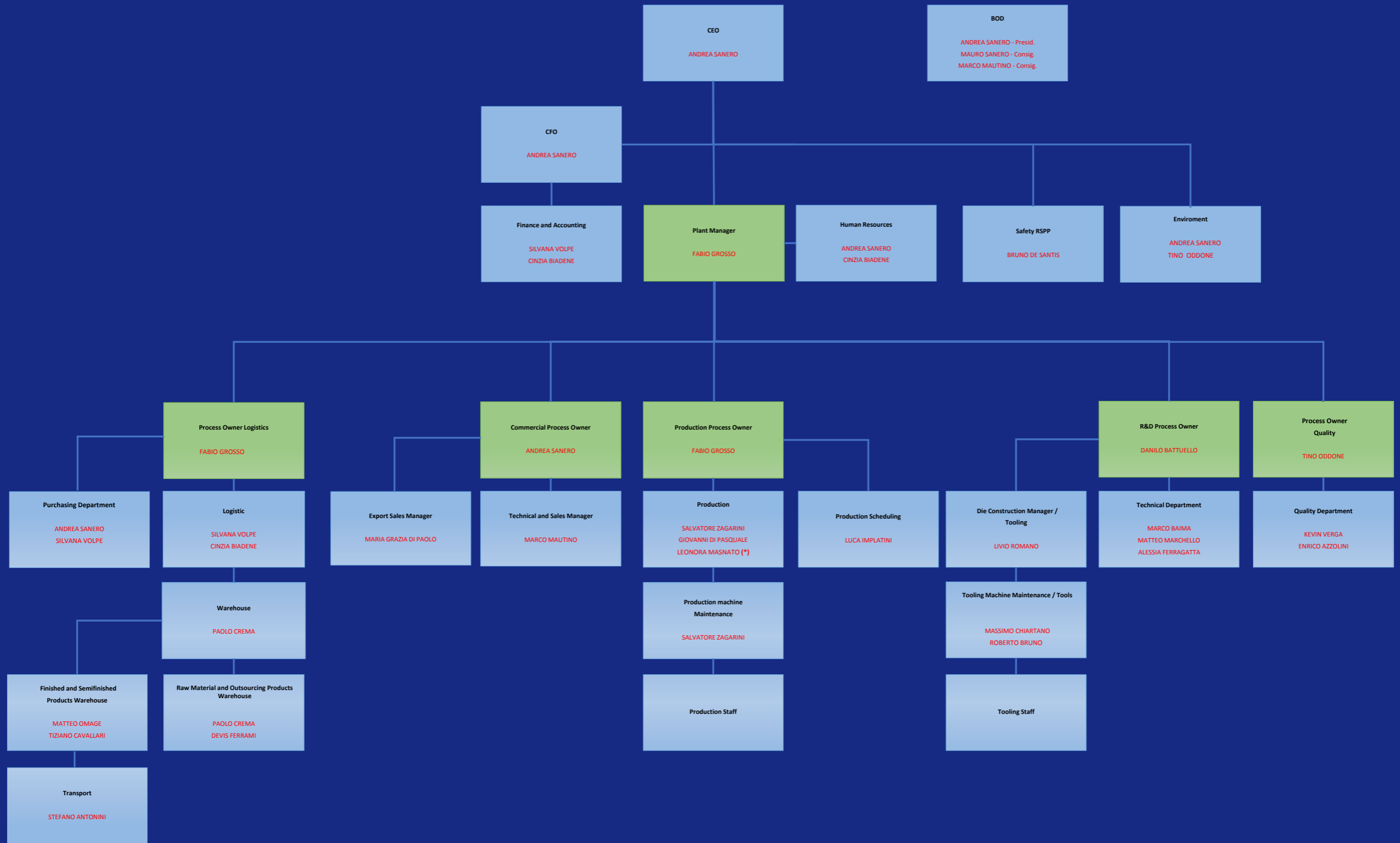

SECTOR OF COMPLIANCE

- Automotive - 50%
- Household appliances - 10%
- Data processing systems - 10%
- Safety belts - 10%
- Electronics - 20%



We have business with more than 20 foreign markets.

Main customers

- FCA (Fiat group)
- BITRON GROUP
- IMMI
- VOLKSWAGEN
- METHODE ELECTRONICS MALTA
- ELBI INTERNATIONAL
- CEBI / ELTH
- VALEO
- FACET
- FARA
- FEKA (FETKA)
- MASERATI
- MCF
- NEOHM
- BREMBO
- STAMET
- VISHAY
- ZADI GROUP
- CECOMP GROUP
- OMA
- DENSO
- REMY AUTOMOTIVE
- SABELT
- BOSCH
- DELPHI
- CELLINO GROUP
- ARCA TECHNOLOGIES
- SMITHS CONNECTORS
- LITTELFUSE
- TIBERINA TURIN

ENGINEERING

Experience, innovation
and design flexibility.

During the tool design, development and construction phases, design and construction solutions are suggested and agreed with the client that allow us to save on materials and production time, that ensure the quality of the finished product and that require less tool maintenance.

The design department is equipped with several CAD/CAM (Visi-CAD) terminals (four CAD terminals and three CAM terminals), and "AUTOFORM", offering the option of calculating, viewing in 3D and transmitting online the final designs to our CNC machines.

Design analyses, feasibility studies and co-design projects are developed in partnership with our clients.

CAD formats used:

- DXF-DWG
- IGES
- Parasolid
- Solid Edge
- Solid Works
- Step
- STL
- VDA
- VISI CAD

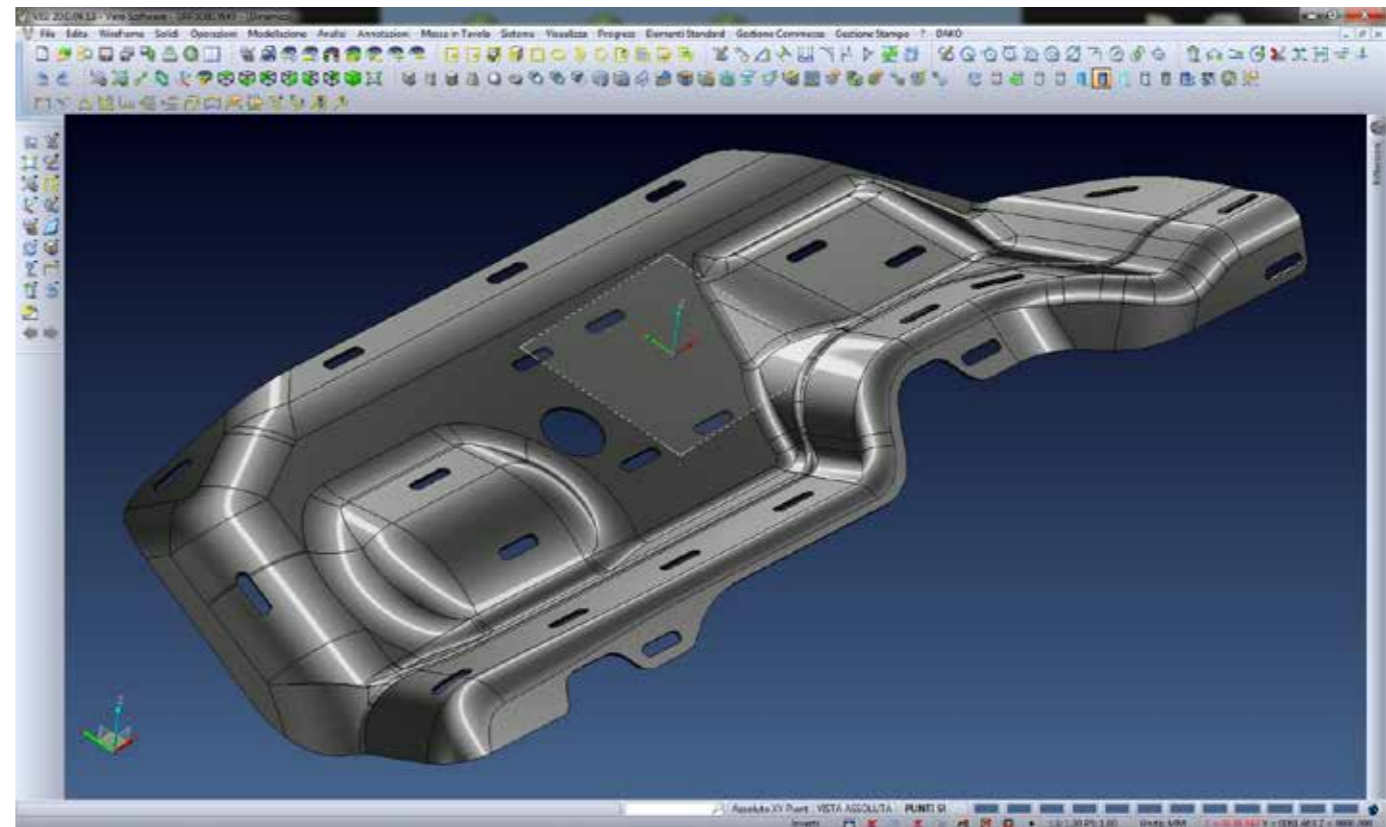

COLD PRESSING

The stamping department is equipped with **35 mechanical presses** ranging from **16-400 tonnes**.

The production cycle is completed with the use of machines for shaving, washing and drying stamped parts as well.

The materials used to produce stamped parts include various kinds of sheet metal (steel, stainless steel, copper), alloys (bronze, brass, nickel silver) or special compounds (tri-metals, alpacca etc.), with thicknesses from **0,05 mm to 7 mm**.

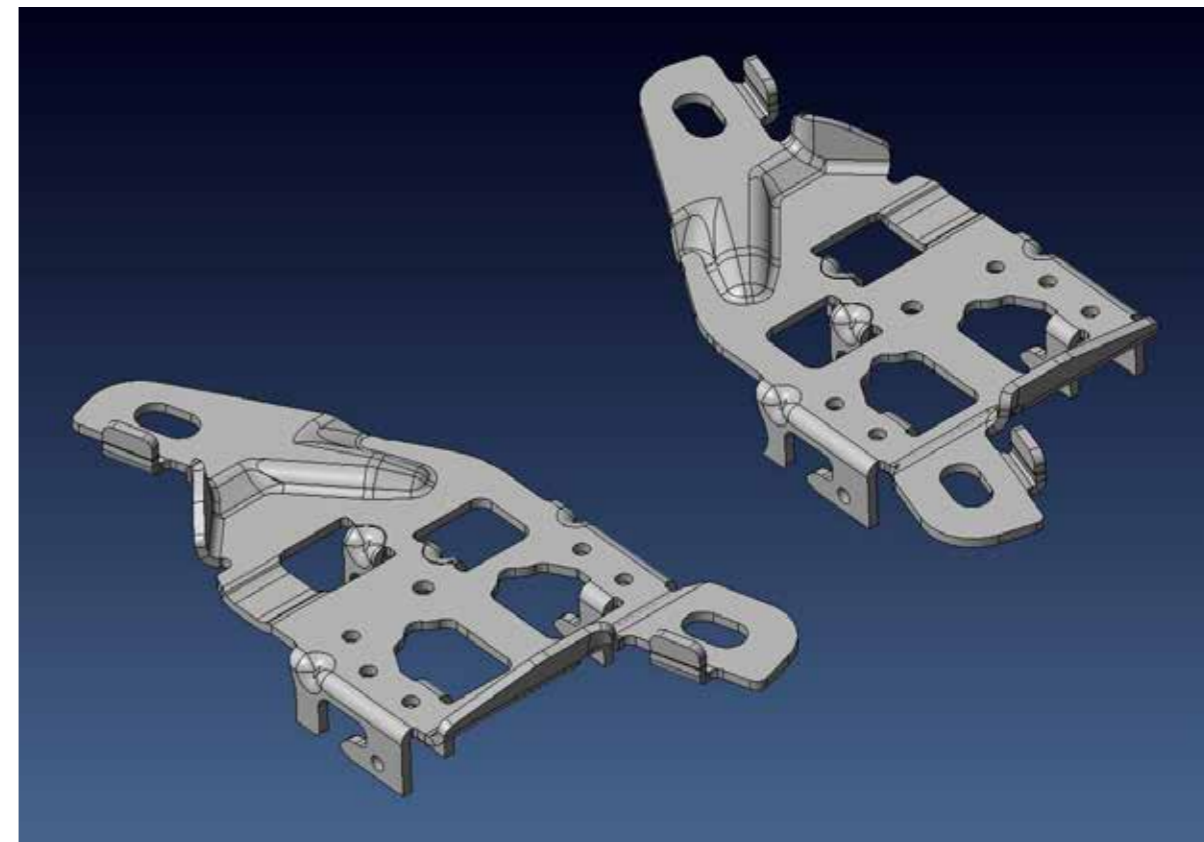
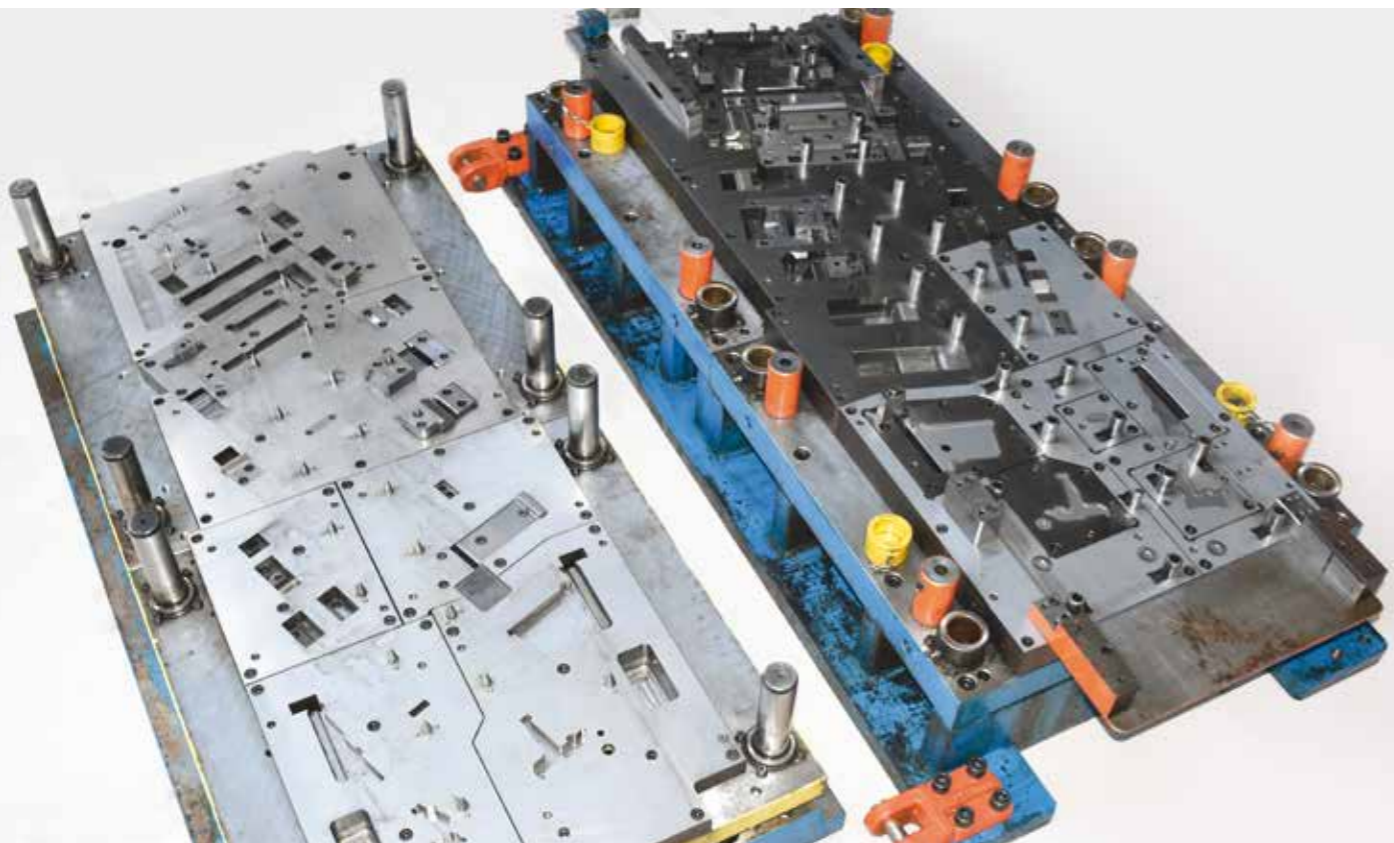

OUR PRODUCTS AND PROCESSES

For heat and surface treatments, NUOVA SIMACH S.r.l. turns to specialized companies with whom it has established a long-standing relationship, with excellent results in terms of quality; total and selective treatments are done on tapes and on finished parts, such as:

Tinning, Galvanizing, Silver and Gold plating, Gilding, Varnishing, Degreasing, Burnishing, Nickel Plating etc.

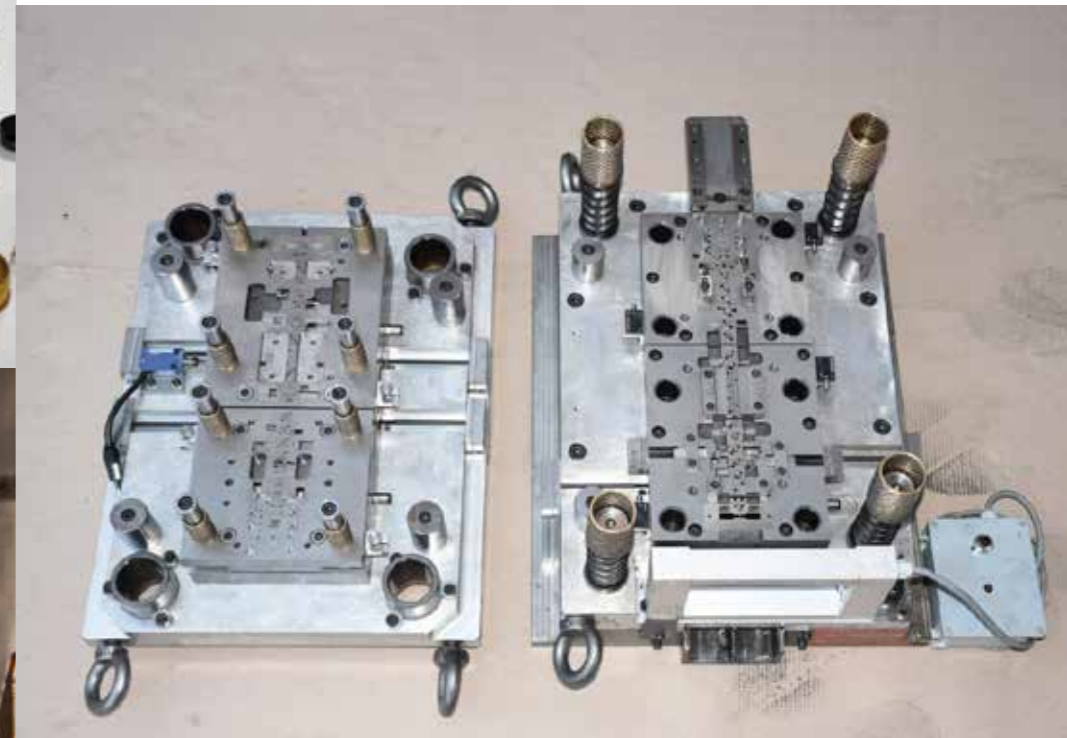

READY FOR THE FUTURE

Great experience in car electrification
Copper alloy and aluminium co-molded



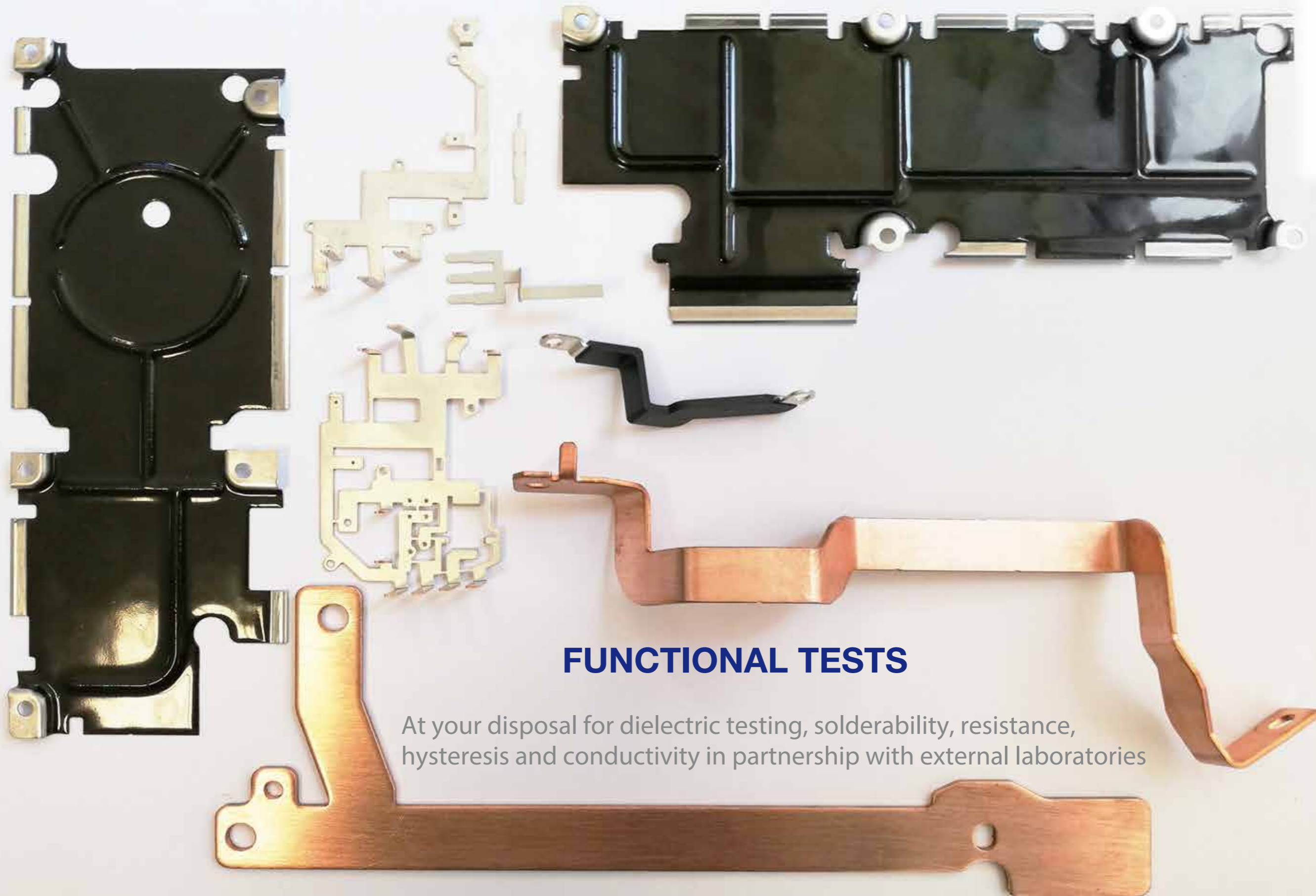

FUNCTIONAL TESTS

At your disposal for dielectric testing, solderability, resistance, hysteresis and conductivity in partnership with external laboratories

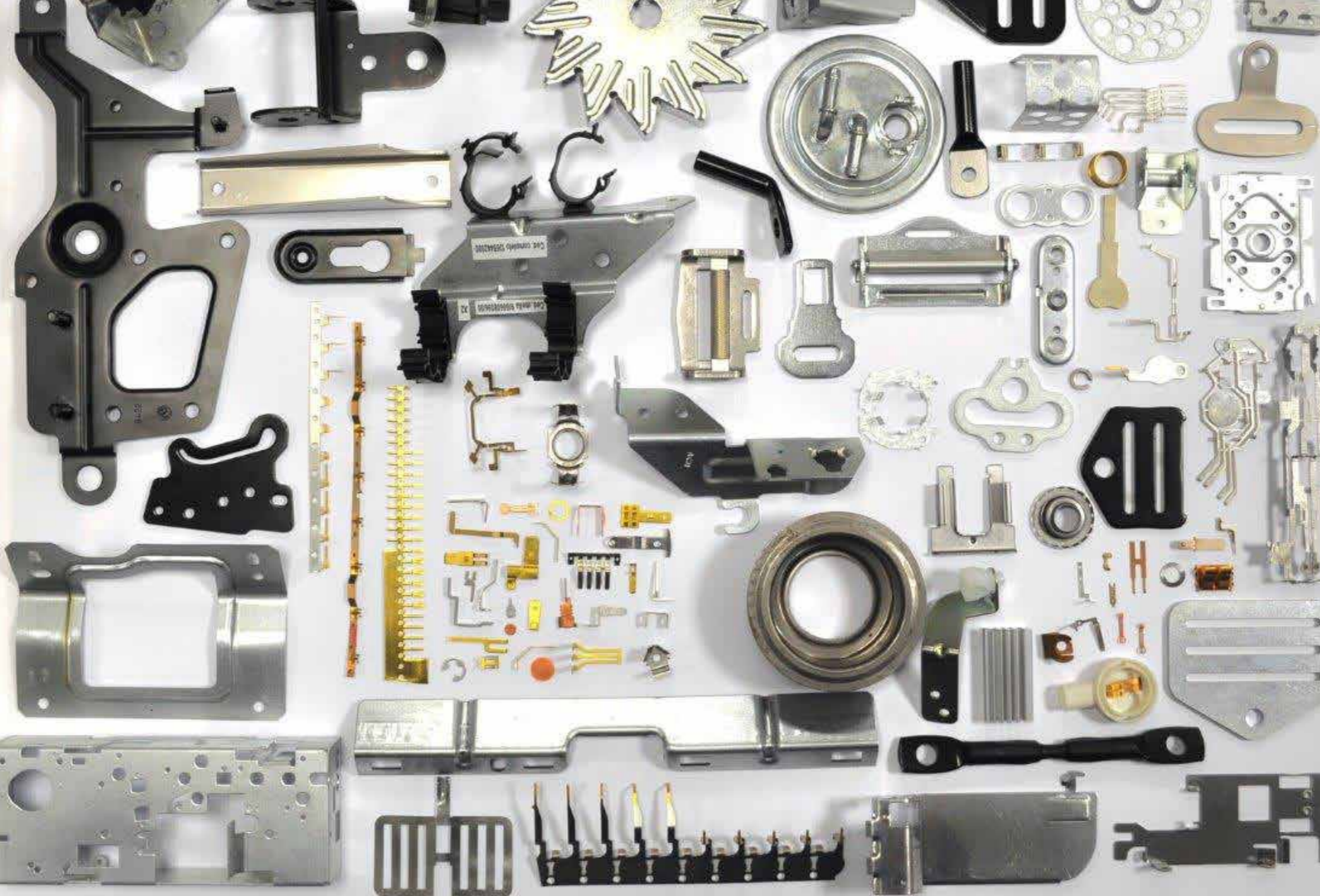









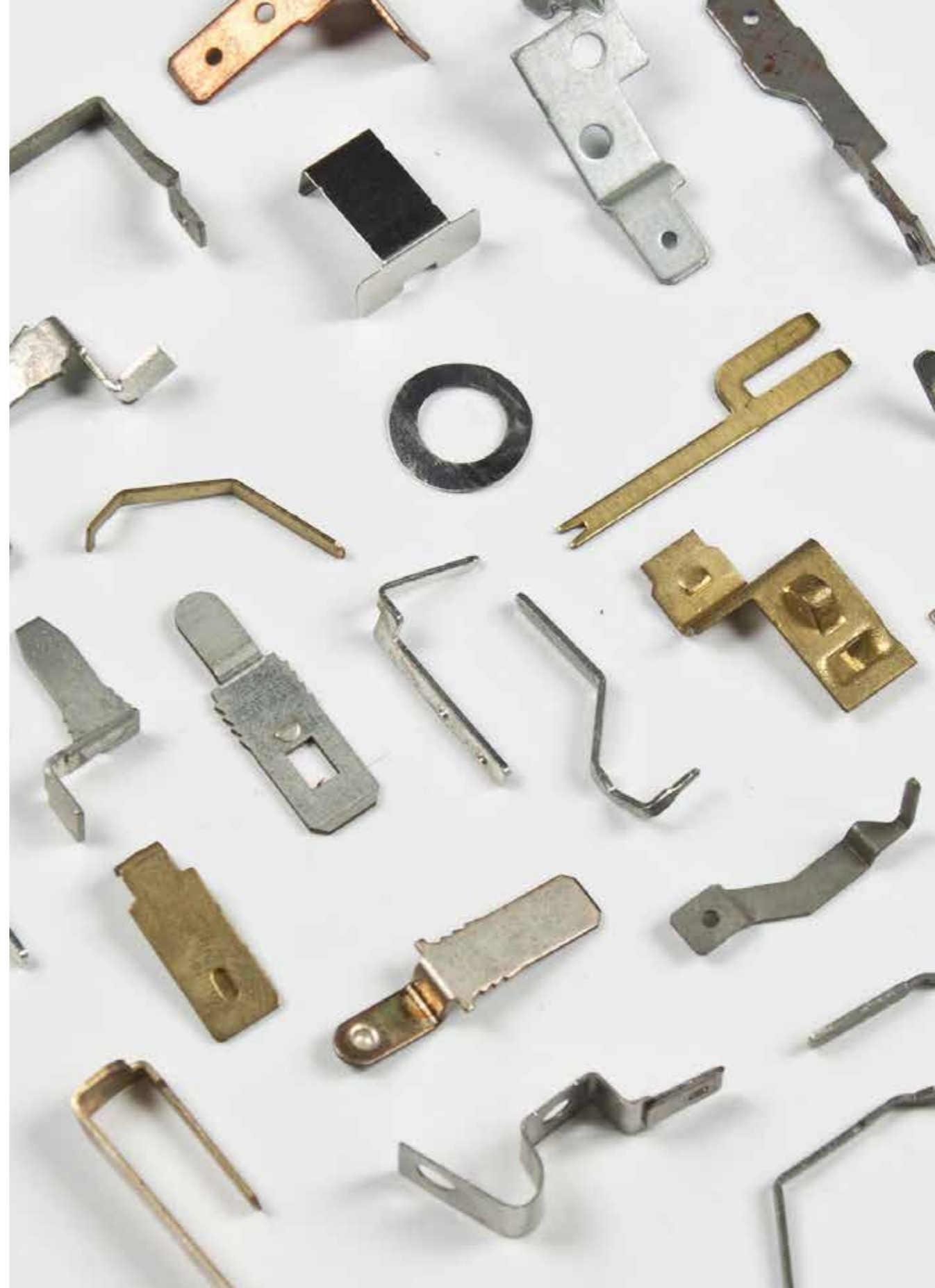
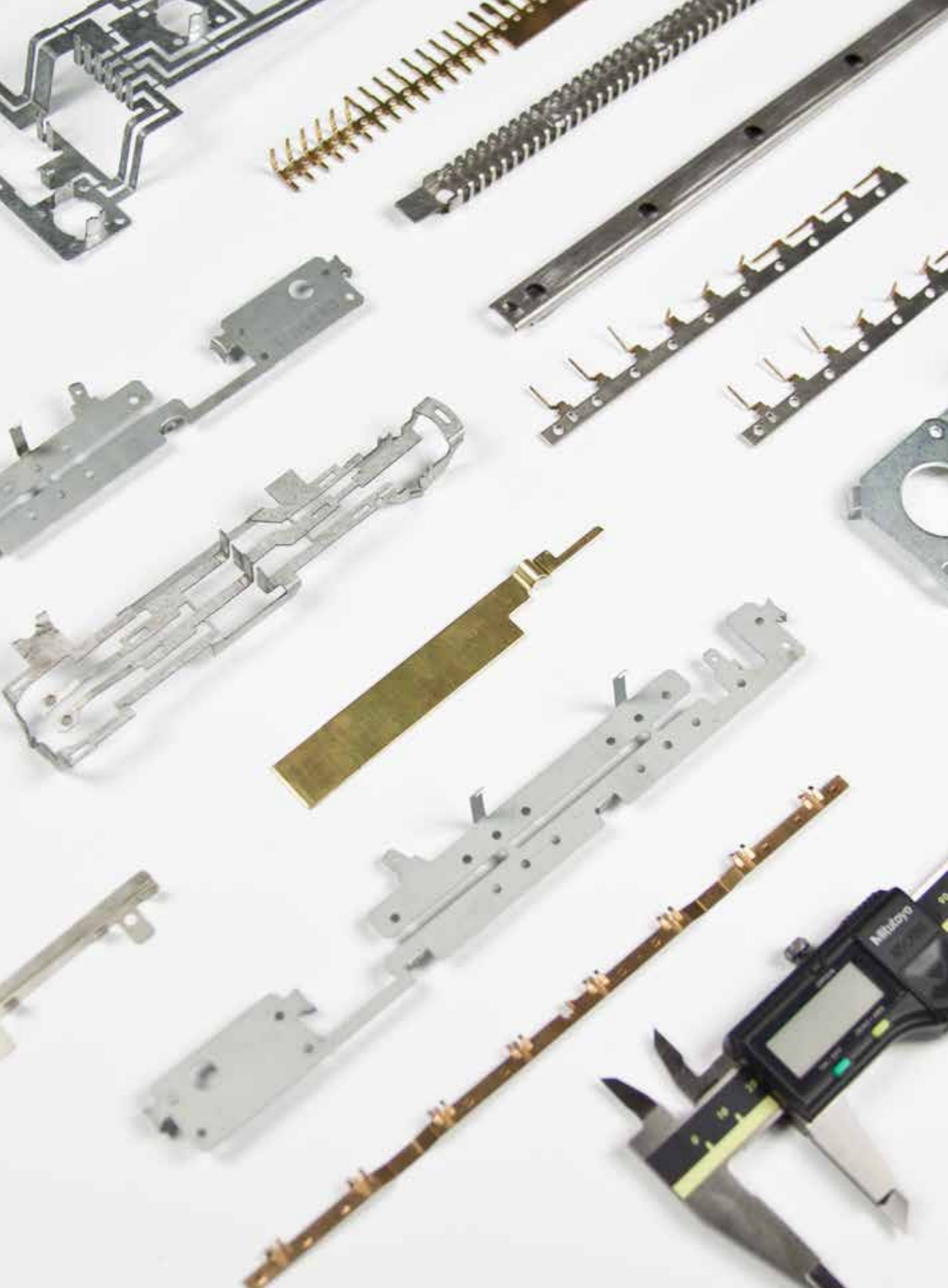

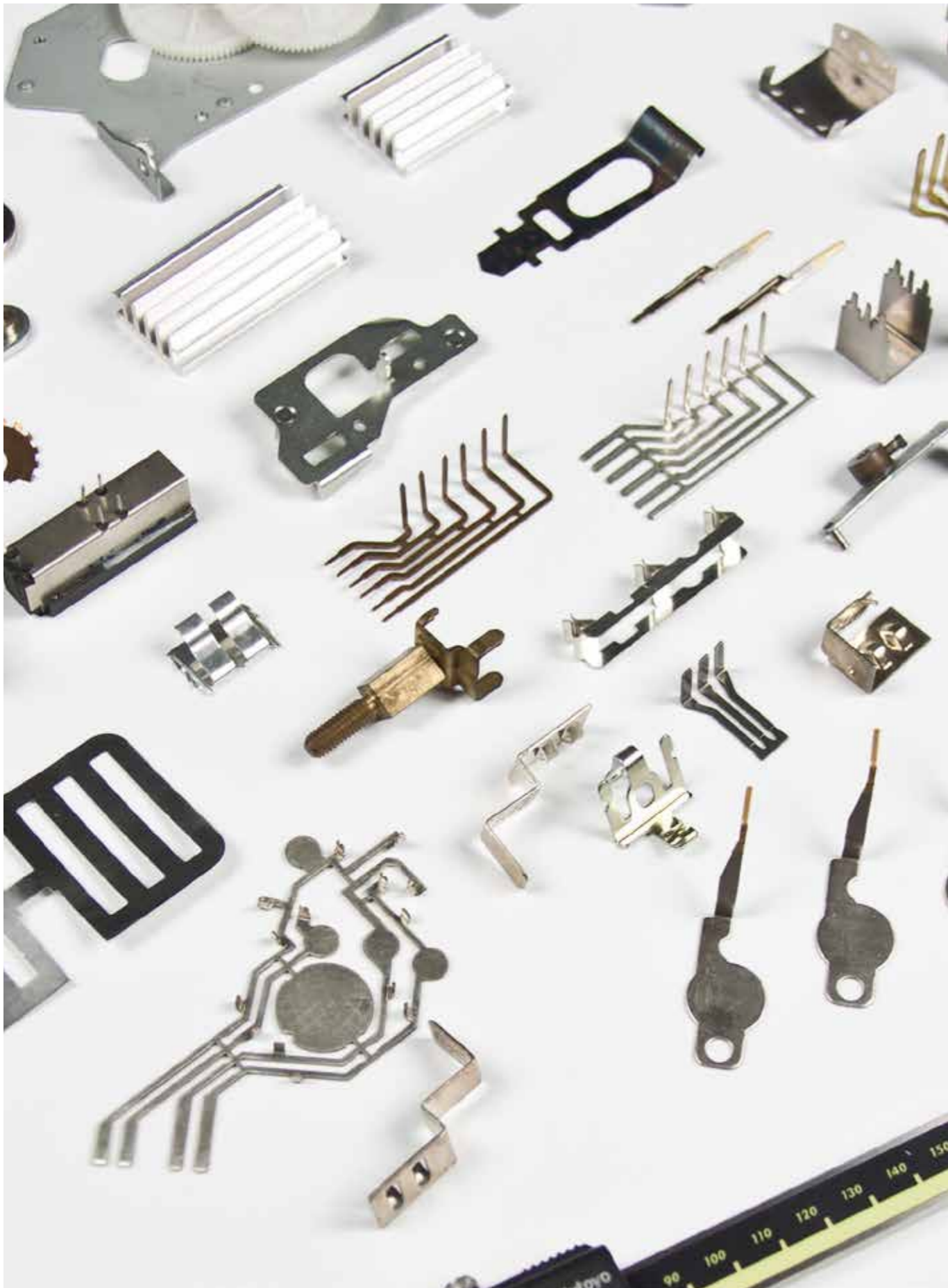

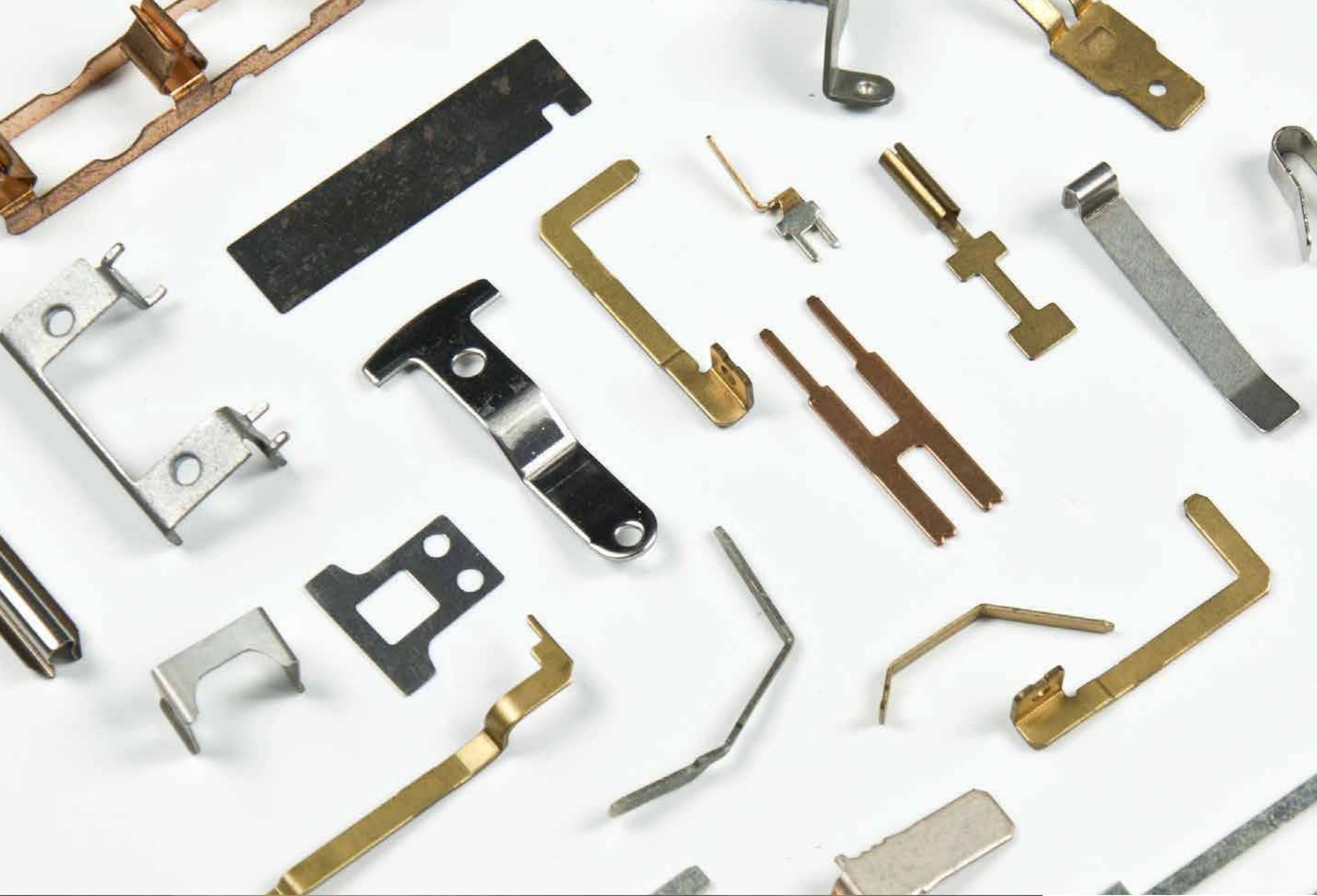



QUALITY

Quality is of the utmost importance to our company, as stated in our quality policy. This commitment led to attaining **ISO 9001:2015 e IATF 16949:2016**



Quality is not only a target, but a strong constant.

NUOVA SIMACH S.r.l. is equipped with technological-ly advanced instruments, that allows to make accurate and detailed measurements, such as:

- Tesa Visio 200 3D optical measurements
- Mitutoyo Ph 3500 + two-dimensional software
- Poli Sky 3 + Capps Software
- Coating thickness meter sauter TG 1250
- Affri 206 RSD Hardness tester
- Mitutoyo SJ 301 Surface Roughness Tester
- Microscope
- Galdabini Sun 5 traction tests
- Keyence IM - 7000

Our management does not consider this a final result, but rather a point of departure for further, constant improvement.



A diagonal, close-up photograph of metal stamped parts, showing various shapes and textures, occupies the left side of the page. The parts are arranged in a way that creates a sense of depth and repetition.

Nuova Simach

Design, dies construction and stamping.

Reg. Chiria, 6 - 10080 Lusiglie' (TO)

T. +39 0124 300079

F. +39 0124 302008

info@nuovasimach.it

www.nuovasimach.it